

# Demolition Tools

## Introduction

Our manufacturing experience on Demolition Tools covers a period of over thirty years, throughout which we have continued to develop high quality tools for an ever-demanding marketplace.

P&V has one quality - the best. All tools are totally manufactured and processed within our modern factory, utilising the very latest machinery and technology, which ensures that our finished products comply with the high standards of quality expected by our customers worldwide. We operate a Quality Management System which is certified to BS EN ISO9001 standard.

Our Demolition Tools are manufactured from specially selected steel specifications which have been evolved from a rigorous research and development programme. We continually investigate refinements to specifications and processes, to ensure that our quality leads the market.

P&V's in-house Heat Treatment Plant is one of the largest of its kind in Europe and enables us to closely control and monitor all aspects of the unique processes we have developed.

The result is a range of quality Demolition Tools that have the hardness, impact strength and durability required to combat the most arduous conditions experienced in demolition, trenching, road construction, quarrying and mining applications.

P&V's Demolition Tools are acknowledged by many major OEMs as the best independently produced tools available worldwide. One quality - the best.

---

## Contents

	Page		Page
Introduction	1	Krupp	31-34
Warranty	2	Montabert	35-39
Tools Selection	2	MSB	40-42
Care and Use	3	NPK	43-47
Catalogue Numbering System	4	Rammer	48-52
Chisel Orientation	4	Rotair	53
Machine Index	5	Socomec	54-55
Hammer Type & Tool Reference Index	6-12	Soosan	56-58
Atlas Copco	13-17	Toku	59-61
Furukawa	18-21	Toyo	62-64
Hanwoo	22-23	Other Manufacturers Reference Index	65-66
Indeco	24-27	Warranty Guide	67-68
Italdem	28-30		

# Warranty

Padley & Venables' tools are guaranteed against defects in raw material and manufacture. No other warranty is implied or expressed. The company's liability in respect of any warranty claims is limited to replacement and does not extend to any other expenditure incurred or to any consequential damage. Warranty claims are subject to immediate notification of any problems and return of the goods to P&V under their returned goods system. See pages 67 & 68 for our full warranty details

# Tools Selection

Correct selection of tools is the first step in obtaining maximum life from the product.

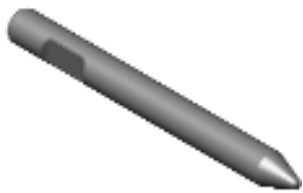

**Conical Point** - for general demolition work where penetrative breaking is required.



**Pyramid Points** - for use where increased breakout forces are required



**X Type Point** - for use in soft or high dust operations.

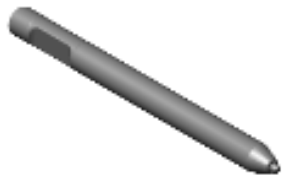

**Power Point** - tool with hard core for use in very hard and abrasive conditions.



**Chisels** - as for Points but also where a cutting action is required, eg. trenching and benching  
*Note: Chisels give higher wear rates and stress levels in the retainer flat areas of the tool.*



**Grooved Chisel** - for use in soft or high dust operations.



**Wide Chisels** - for increased productivity in softer materials.  
**Tarmac Cutters** - as Wide Chisels but with 90 degree orientation for cutting/trenching.



**Rail Guard** - for driving in rail guards.



**Blunts** - for impact breaking, eg. secondary breaking and also scaling in mines and tunnels, etc.



**Upset Blunt** - Blunt with increased diameter at working end to give increased life and wear resistance.



**Rammer Stems & Pads** - for compacting loose ground.



**Driving Tool** - for driving in posts, pipes etc.

# Care and Use

## **Working Angle**

Critical to tool life is using the tool at the correct working angle of 90° to the working surface. Failure to do this will result in high contact pressure between the tool and the bushings and the likelihood of galling between the surfaces. In turn this can lead to premature failure of the tool plus damage and rapid wear to the bushings. Worn bushings can allow the tool to be angled over to a position where the striking face is hit at an angle by the piston.

## **Lubrication**

Lubrication of the tool/bushing with the correct quality high temperature/high pressure grease at regular intervals is essential. Such greases are best able to cope with the extreme contact pressures generated by an incorrect working angle, leverage and excessive bending etc.

**USE OF CHEAP SUBSTITUTES (OR NO GREASE AT ALL) IS FALSE ECONOMY AND WILL RESULT IN PREMATURE TOOL FAILURE.**

## **Blank Firing**

Continuing to use the hammer when the tool is not or only partially in contact with the work surface will result in the tool being fired down on to the retainer pin. This will cause heavy wear and damage to the upper retainer flat radius area and the retaining pin itself.

Tools should be examined regularly, eg. every 40 hours for damage in this area which should then be ground out.

At the same time as the tool is examined the opportunity should be taken to check the tool bushings for wear and damage with a view to replacement or reconditioning as necessary.

## **Overheating**

Avoid continuous working in one position. Do not strike in one spot for more than 10 - 15 seconds before changing the tool to another position. Failure to do this can lead to excessive heat build-up at the working end with 'mushrooming' as a consequence.

## **Leverage/Bending**

Using the tool as a lever to help break the ground is a common tool breaker. Avoid leverage and excessive bending at all times.

## **Loose running**

Keep the boom and hammer feed sufficient to ensure that the tool is held against the hammer shoulder stop, at all times when working.

## **Tool Reconditioning**

Under most normal conditions the tool will not need reconditioning. However, tools that have lost their shape on the working end can cause high stresses throughout the tool and hammer. Reconditioning by milling or turning is recommended. Welding or flame cutting is not recommended as the heat generated could cause structural changes within the material which in turn can lead to premature failure or rapid wear.

# Catalogue Numbering System

All catalogue numbers start with the letter 'D', followed by a 3 digit number, which is the P&V designation for the hammer type, eg. **D001-0410P**.

The second section defines the tool length and type, eg. **D001-0410P**. The first 4 digits eg. **0410** represent the tool length in millimetres, whilst the working end configuration is defined by a letter:

- |                       |  |
|-----------------------|--|
| 'P' = Point (Conical) | 'WC' = Wide Chisel, followed by blade width, eg. D001-0410 <b>WC-120</b> |
| 'C' = Chisel          | 'TC' = Tarmac Cutter (in-line wide chisel) eg. D001-0410 <b>TC-120</b>   |
| 'B' = Blunt           |  |
| 'PP' = Pyramid Point  |  |
| 'XP' = 'X' point      |  |
| 'GC' = grooved chisel |  |
| 'BU' = blunt upset    |  |
| 'CT' = Power Point    |  |

For correct selection of tool types see page 2

Note: For special tools such as Railguards, Rammer Stem & Pads and Driving Tools, please contact our sales office.

## Chisel Orientation

Transverse (East/West) have the blade of the tool transverse to the axis of the carrier boom when mounted.

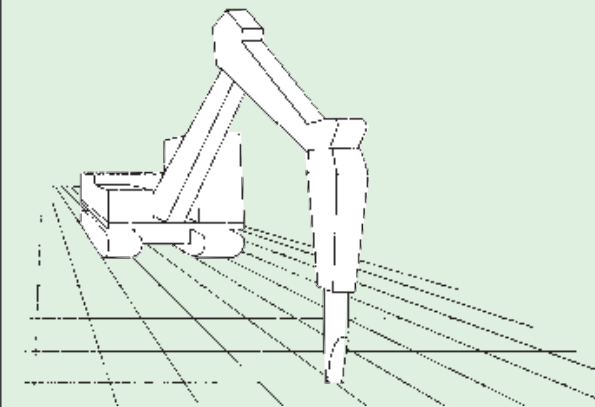

All standard chisels and wide chisels have the blade in the transverse mode.

In-Line (North/South) have the chisel tool blade "In-Line" (parallel) to the axis of the carrier boom.

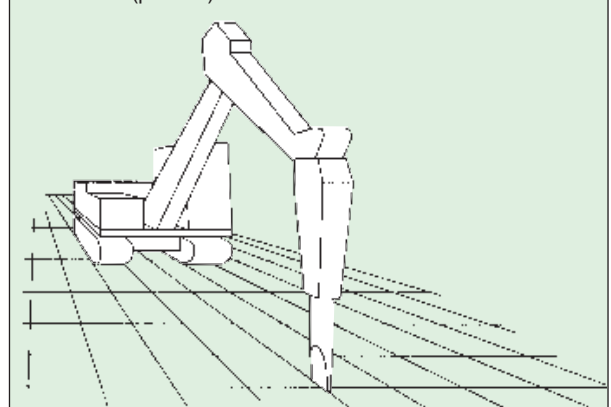

All in-line chisels and tarmac cutters have the blade in the "in-line" mode.

# Machine Index

Machine	Page	Machine	Page
ARDEN	65	MONTABERT	35-39
ARROWHEAD	46, 65	MSB	40-42
ATLAS COPCO	13-17	NPK	43-47
BERCO	13	OCM	35-36
BOBCAT	65	O&K	48-52
CASE	48-51	OKADA	66
CATERPILLAR	48-52	OMAL	35, 53
CHICAGO PNEUMATIC	13, 16-17, 33-34	OMD	35
DAEMO	65	PEL-JOB	53
D&A	65	PROMOVE	35-36
DEHACO	62-64	RAMMER	48-52
DRAGO	59-60	ROTAIR	53
EURORAM	24-27	SOCOMECH	54-55
FURUKAWA	18-21	SOOSAN	56-58
GEHL	53	STANLEY	56-58, 66
HANWOO	22-23	STAR	28-29, 35-36
HUSKIE/IZUMI	65	TABE	66
IDROMECCANICA	35	TAKEUCHI	62-64
INDECO	24-27	TELEDYNE	59-61
ITALDEM	28-30	TOKU	59-61
JCB	48-52	TOPA	66
JKHB	62-64	TOYO	62-64
KRUPP	31-34	VIBRARAM	66
KUBOTA	48	VOLVO	48-52
LIFTON	65	WIMMER	40-41



# Hammer Type & Tool Reference Index

Machine	Fig. No.	Page	Machine	Ref. No.	Page
<b>ARDEN</b>			<b>ATLAS COPCO - cont.</b>		
AB100	275	65	TEX 1400H	16	15
AB150/210	276	65	TEX 1800H/2000H	17	15
AB280/350	277	65			
AB450	279	65	<b>BERCO</b>		
AB1050	280	65	BB42	1	13
			BB52	2	13
<b>ARROWHEAD</b>			BB62	3	13
S20	281	65	BB70	4	13
S30	282	65	BB80	5	13
S40	283	65			
S60	284	65	<b>BOBCAT</b>		
			B300	126	36
2T	176	46	B500	127	36
4T	178	46	580	137	38
6T	179	46	680	138	38
10T	285	65	B700	128	37
22T	286	65	B850/B950	129	37
			880	139	38
<b>ATLAS COPCO</b>			980	140	39
PB110	1	13	1250	329	65
PB160	2	13	1560	330	65
PB210	3	13	1750	187	48
PB310	4	13	2500/2570/3560	331	65
PB420	5	13	5500	332	65
			6560	333	65
SB50,SBC 60	6	13	<b>CASE</b>		
SB100,SBC 115	7	14	CB140	187	48
SB150,SBC 255	8	14	CB200	188	48
SB200,SBC 410	9	14	CB370	189	48
SB300,SBC 610,SBC650	10	14	CB620	190	48
SB300 SCALER	11	14	CB735	192	49
SB450,SBC 800/850	14	15	CB1150	193	49
			CB1450	203	50
MB500	19	16	CB2850	205	51
MB700, MB800	20	16	CB3750	206	51
MB1000	21	16	CB4000	207	51
MB1200	22	16	CB5200	208	51
MB1700	23	16			
			<b>CATERPILLAR</b>		
HB2200	24	16	CAT H45FT	187	48
HB3000	25	17	CAT H50FT	188	48
HB4200	26	17	CAT H63/H63FT	189	48
HB5800	27	17	CAT H70/H70FT	190	48
HB7000	28	17	CAT H90/H90FT	192	49
			CAT H100/H100FT	193	49
HBC 1100/1700	15	15	CAT H115s	203	50
HBC 2500	16	15	CAT H120s	205	51
HBC 4000	17	15	CAT H130s	206	51
HBC 6000	18	15	CAT H140As	199	50
			CAT H140Cs/H140Ds	207	51
TEX 30H	6	13	CAT H160As	200	50
TEX 75H/100H	7	14	CAT H160Cs/H160Ds	208	51
TEX 110H	8	14	CAT H180s	209	51
TEX 180H	9	14	CAT H180Ds	210	52
TEX 250H	12	14	CAT H195	211	52
TEX 250H SCALER	13	15			
TEX 400H	14	15			
TEX 600H/700H/900H	15	15			

# Hammer Type & Tool Reference Index

Machine	Fig. No.	Page	Machine	Fig. No.	Page
<b>CHICAGO PNEUMATIC (CP)</b>			<b>EURORAM - contd.</b>		
CP100	1	13	RM80	67	24
CP150	2	13	RM85/90	70	25
CP200	3	13	RM110	71	25
CP300	4	13	RM115	72	25
CP400	5	13	RM120	73	25
CP550	5	13	RM130	74	26
CP750	105	32	RM140	75	26
CP1150	108	33	RM145	76	26
CP1550	110	33	RM150	77	26
CP2250	112	34	RM160	78	27
CP3050	114	34	RM180	79	27
CP4250	115	34	RM195	80	27
<b>DAEMO</b>			<b>FURUKAWA</b>		
DMB S500	287	65	F1	29	18
DMB S1300	288	65	F2	30	18
DMB S1800	289	65	F3	31	18
DMB S2200	290	65	F4	32	18
DMB S3000	291	65	F5	33	18
DMB S3600	292	65	F6	34	18
<b>D&amp;A</b>			F9	35	19
8V	275	65	F12	36	19
15V/20V	276	65	F19	37	19
30V/50V	277	65	F22	38	19
70V	278	65	F27	39	19
130V	280	65	F35	40	19
180V	293	65	F45	41	20
<b>DEHACO</b>			F70	42	20
DHB 35	261	62	HB1G	43	20
DHB 55	262	62	HB2G	44	20
DHB 75	263	62	HB3G	45	20
DHB165	264	62	HB5G	46	20
DHB 305	266	63	HB8G	47	21
DHB 405	267	63	HB10G	48	21
DHB 805	268	63	HB15G	49	21
DHB 1250	269	63	HB20G	50	21
DHB 1305	270	63	HB30G	51	21
DHB 1605 (1405)	271	64	HB40G	52	21
DHB 2305	272	64	<b>HANWOO</b>		
DHB 3205 (4105)	273	64	RHB 301-V	53	22
<b>DRAGO</b>			RHB 302/303-V	54	22
DRH 80	246	59	RHB 303	55	22
DRH120	247	59	RHB 305-V	56	22
DRH150	248	59	RHB 308-2/309	57	22
DRH180	249	59	RHB 313-V	58	22
DRH280	250	59	RHB 322-2/325	59	23
DRH650S/900	251	60	RHB 328-2/330	60	23
DRH1150S/1600S	252	60	RHB 340	61	23
DRH1900	253	60	<b>HUSKIE/IZUMI</b>		
<b>EURORAM</b>			HH100	294	65
RM45	62	24	HH150	295	65
RM48	63	24	HH300	296	65
RM56	64	24	HH500	297	65
RM65	65	24	HH750	298	65
RM75	66	24	HH1000	299	65
			HH2000	300	65

# Hammer Type & Tool Reference Index

Machine	Fig. No.	Page	Machine	Fig. No.	Page
<b>HUSKIE/IZUMI - contd.</b>			<b>INDECO - contd.</b>		
HH3600	301	65	UP900	69	25
HH4500	302	65	UP1200	70	25
<b>IDROMECCANICA</b>			UP1500	71	25
IMI 85	118	35	UP1750	72	25
IMI 260	120	35	UP2000	73	25
IMI 600	121	35	UP2500	74	26
IMI 1000	122	35	UP3000	75	26
<b>INDECO</b>			UP3500	76	26
HB5	65	24	UP4000	77	26
HB8	67	24	UP5000	78	27
HB12	70	25	UP7000	79	27
HB19	71	25	UP8500	80	27
HB27	73	25	<b>ITALDEM</b>		
HP150	62	24	GK 85/86	81	28
HP200	63	24	GK 160/161	82	28
HP350	64	24	GK211	83	28
HP500	65	24	GK 290/291	84	28
HP600	66	24	GK 360/361	85	28
HP700	68	25	GK 600/610	86	29
HP900	69	25	GK 950/960	87	29
HP1200	70	25	GK 1350	88	29
HP1500	71	25	GK1351S	89	29
HP1800	72	25	GK 1600	90	29
HP2000	73	25	GK 2400	91	30
HP2500	74	26	GK 3400/3500	92	30
HP3000	75	26	GK3800	93	30
HP3500	76	26	K 80	118	35
HP4000	77	26	K 270	120	35
HP5000	78	27	K 550	121	35
HP7000	79	27	K 1000	122	35
HP9000	80	27	K 1030	124	36
MES 121/150	62	24	K 1300	125	36
MES 180/181/200	63	24	<b>JCB</b>		
MES 300/301/350/351	64	24	JCB HM160	187	48
MES 451/452/462/521/550	65	24	JCB HM260	189	48
MES 553	66	24	JCB HM360	190	48
MES 601/621/650	68	24	JCB HM550	192	49
MES 1200	70	25	JCB HM850	193	49
MES 1500	71	25	JCB HM1050	203	50
MES 1750/1800	72	25	JCB HM1150	202	50
MES 2000	73	25	JCB HM1350	205	51
MES 2500	74	26	JCB HM1450	204	51
MES 3000	75	26	JCB HM1750	206	51
MES 3500	76	26	JCB HM2350	207	51
MES 4000	77	26	JCB HM2950	208	51
MES 5000	78	27	JCB HM3850	209	51
MES 7000	79	27	JCB HM3950	210	52
MES 8500	80	27	<b>JKHB</b>		
UP121/150P	62	24	JKHB 31	261	62
UP181/200P	63	24	JKHB 51	262	62
UP301/350P/351P	64	24	JKHB 71	263	62
UP462/521/550P	65	24	JKHB 101	264	62
UP553	66	24	JKHB 301	266	63
UP621/650P	68	25	JKHB 401	267	63
			JKHB 801	268	63



# Hammer Type & Tool Reference Index

Machine	Fig. No.	Page	Machine	Fig. No.	Page
<b>JKHB - contd.</b>			<b>MONTABERT - contd.</b>		
JKHB 1101	269	63	BRH501/570	122	35
JKHB 1401	270	63	BRH620	123	36
JKHB 1600	271	64	BRH625	124	36
JKHB 2000	272	64	BRH750	125	36
JKHB 3000	273	64	30	126	36
<b>KRUPP</b>			50/50SMS	127	36
AT20	1	13	70/70SMS	128	37
AT70	2	13	85/85SMS/90/90SMS	129	37
AT120	3	13	125SX	130	37
AT170	4	13	140/140SMS/150/150SMS	131	37
AT220	5	13	300/300MS	132	37
HM50/55	94	31	700/700SMS	133	37
HM60V	95	31	900/900MS	134	38
HM60/75	96	31	1200/1200SMS	135	38
HM85/90/90V	97	31	SILVER CLIP 08 (SC08)	136	38
HM130/140V	98	31	SILVER CLIP 12 (SC12)	137	38
HM185/190V	99	31	SILVER CLIP 16 (SC16)	138	38
HM200	100	32	SILVER CLIP 22 (SC22)	139	38
HM220/230	101	32	SILVER CLIP 28 (SC28)	140	39
HM300/301/305	102	32	V32/V32SMS	141	39
HM350/350V	103	32	V43	142	39
HM550/560V	104	32	V53	143	39
HM580	105	32	<b>MSB</b>		
HM600/601	106	33	MS200	144	40
HM680	21	16	MS250	145	40
HM700/701/702/705	107	33	MS300	146	40
HM710/720	108	33	MS400	147	40
HM780	109	33	MS450	148	40
HM950/960	110	33	MS500	149	41
HM1000	111	33	MS600(NEW)	150	41
HM1500MV	112	34	MS700	151	41
HM2000MV	113	34	MS800	152	41
HM2100/2300	114	34	MS900	153	41
HM2500MV/2600	115	34	SAGA 1000	154	42
HM3000	116	34	SAGA 1500	155	42
HM4000	117	34	SAGA 2000	156	42
<b>KUBOTA</b>			<b>NPK</b>		
KXB 300/350	186	48	E-102	157	43
KXB 400/BTB400	187	48	E-106	158	43
KXB 450	188	48	E-200	159	43
KXB 500	189	48	E-201	160	43
KXB 600	190	48	E-202	161	43
<b>LIFTON</b>			E-203	162	43
LH70/80	303	65	E-204	163	44
LH110	304	65	E-205	164	44
LH170	305	65	E-206	165	44
LH360	306	65	E-207	166	44
LH500	307	65	E-208A	167	44
LH1000	308	65	E-210	168	44
<b>MONTABERT</b>			E-213	169	45
BRH40	118	35	E-216	170	45
BRH76/91	119	35	E-220	171	45
BRH125	120	35	E-225	172	45
BRH250/270	121	35	E-240A	173	45

# Hammer Type & Tool Reference Index

Machine	Fig. No.	Page	Machine	Fig. No.	Page
<b>NPK - contd.</b>			<b>OMAL</b>		
GH10	174	45	OMAL 80	118	35
H-06X	175	46	OMAL 80S	216	53
H-08XA	176	46	OMAL 270	120	35
H-1XA	177	46	OMAL 500	121	35
H-2XA/E	178	46	OMAL 1000	122	35
H-3XA/E	179	46	<b>OMD</b>		
H-4X	180	46	OMD 8	118	35
H-6XA	181	47	OMD 30	120	35
H-7XA	182	47	OMD 50	121	35
H-8XA	183	47	OMD 100	122	35
H-10XB/E	184	47	<b>PEL-JOB</b>		
H-12X/E	185	47	MH90	216	53
<b>OCM</b>			MH95	217	53
OCM8	118	35	MH130/160	218	53
OCM25	120	35	MH180/260	219	53
OCM55	121	35	<b>PROMOVE</b>		
OCM100	122	35	P22	124	36
OCM130	125	36	PMV90/P3SH	118	35
<b>O&amp;K</b>			PMV290/390/P12SH	120	35
H32	187	48	PMV690/P16SH	121	35
H45	188	48	PMV1000/P23SH	122	35
H65	189	48	PMV1390/P27SH	125	36
H85	190	48	<b>RAMMER</b>		
H120	192	49	S18/PICCOLO	186	48
H150	193	49	S21	187	48
H200	203	50	S22	188	48
H260	205	51	S23	189	48
H310	206	51	S25	190	48
H380	207	51	S26	191	48
H530	208	51	S27	192	49
H700	210	52	S29	193	49
<b>OKADA</b>			S52	194	49
OKB/UB 301	309	66	S54	195	49
OKB/UB 301SL	310	66	S55	196	49
OKB/UB 302	311	66	S56	197	49
OKB/UB 302A	312	66	S82	198	50
OKB/UB 303A	313	66	S83	199	50
OKB/UB 304	314	66	S84	200	50
OKB/UB 304B	315	66	S86	201	50
OKB/UB 305	316	66	E63	202	50
OKB/UB 308	317	66	E64	203	50
OKB/UB 310	318	66	E65	204	51
OKB/UB 312B	319	66	E66	205	51
OKB/UB 316	320	66	E68	206	51
OKB/UB 318	321	66	G80	207	51
UB 2	322	66	G90	208	51
UB 4	323	66	G100	209	51
UB 5	324	66	G110	210	52
UB8	325	66	G120	211	52
UB11	326	66	G130	212	52
UB14	327	66	M14	213	52
UB17/OKB17A2	328	66	M18	214	52

# Hammer Type & Tool Reference Index

Machine	Fig. No.	Page	Machine	Fig. No.	Page
<b>ROTAIR</b>			<b>STAR</b>		
OL50	215	53	SH40	118	35
OL90 (WITH COLLAR)	216	53	SH91	81	28
OL 90/95	217	53	SH151	82	28
OL 130/160	218	53	SH200	83	28
OL 180/260	219	53	SH280	120	35
OL 250/330	220	53	SH281	84	28
<b>SOCOMEK</b>			SH560	121	35
DMS 50	221	54	SH561	86	29
DMS 95	222	54	SH990	122	35
DMS 160	223	54	SH991	87	29
DMS 220	224	54	SH1200	124	36
DMS 330	225	54	SH1400	125	36
DMS 430	226	54	SH1402	89	29
DMS740	227	55	<b>TABE</b>		
MD0 550	228	55	AGB 100/175/200	341	66
MD0 750	229	55	AGB 270/275/350/375	342	66
MD0 1450	230	55	AGB 400/475	343	66
MD0 1950	231	55	AGB 700/701/750	344	66
<b>SOOSAN</b>			AGB 1000/1300/1301	345	66
SB10	232	56	AGB 1600/1620	346	66
SB20	233	56	AGB 1800	347	66
SB30	234	56	<b>TAKEUCHI</b>		
SB40	235	56	TKB-31	261	62
SB43	236	56	TKB-51	262	62
SB45	237	56	TKB-71	263	62
SB50	238	57	TKB-101	264	62
SB60	239	57	TKB-201	265	62
SB81	240	57	TKB-301	266	63
SB100	241	57	TKB-401	267	63
SB121	242	57	TKB-801	268	63
SB130/140	243	58	TKB-1101	269	63
SB151	244	58	TKB-1401	270	63
<b>STANLEY</b>			TKB-1600	271	64
MB 125	329	66	TKB-2000	272	64
MB 156	330	66	TKB-3000	273	64
MB 250/256/350/356	331	66	<b>TELEDYNE</b>		
MB 506	235	56	TB100	245	59
MB 550	332	66	TB120/125	246	59
MB 656/675/695	333	66	TB180/225	247	59
MB 800/856	334	66	TB220/325	249	59
MB 1550	335	66	TB275	248	59
MB 1950/1975	336	66	TB400/425 /625	250	59
MB 2950/2975	337	66	TB700/725/750/825	251	60
MB 3950	338	66	TB830	255	60
MB20EX	237	56	TB900/925/975/1000/1025	252	60
MB30EX	238	57	TB980	256	61
MB40EX	239	57	TB1300/1425	253	60
MB50EX	240	57	TB1680	258	61
MB70EX	242	57	TB1825/2075	254	60
MB80EX	243	58	TB2580	260	61
MB100EX	244	58	TB2080	259	61



Figure No.

TYPE	LENGTH MM	CATALOGUE NUMBER	WEIGHT KGS
------	-----------	------------------	------------

1

### Atlas Copco PB110

Berco BB42, Chicago Pneumatic CP100, Krupp AT20

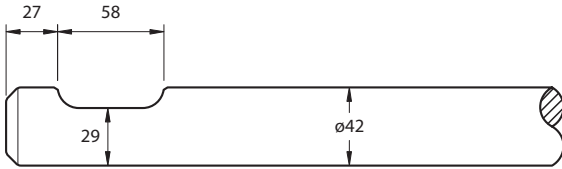

Point  
Chisel

470  
470

**D062-0470P**  
**D062-0470C**

4  
4

2

### Atlas Copco PB160

Berco BB52, Chicago Pneumatic CP150, Krupp AT70

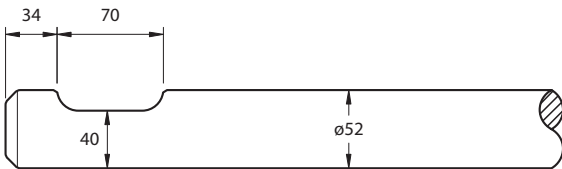

Point  
Chisel

600  
600

**D063-0600P**  
**D063-0600C**

8  
8

3

### Atlas Copco PB210

Berco BB62, Chicago Pneumatic CP200, Krupp AT120

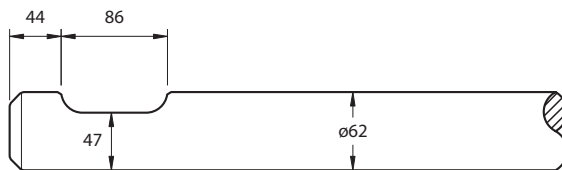

Point  
Chisel

700  
700

**D064-0700P**  
**D064-0700C**

14  
14

4

### Atlas Copco PB310

Berco BB70, Chicago Pneumatic CP300, Krupp AT170

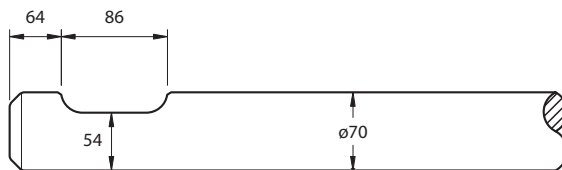

Point  
Chisel

750  
750

**D065-0750P**  
**D065-0750C**

21  
21

5

### Atlas Copco PB420

Berco BB80, Chicago Pneumatic CP400/550, Krupp AT220, HM220/230

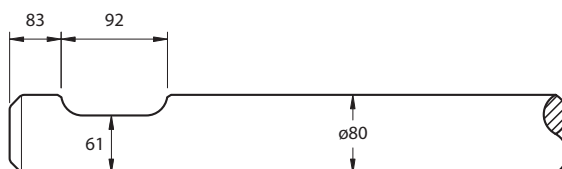

Point  
Chisel

900  
900

**D061-0900P**  
**D061-0900C**

29  
29

6

### Atlas Copco SB50

Atlas Copco SBC60, Tex30H

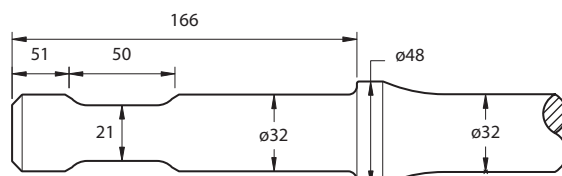

Point  
Chisel

430  
430

**D233-0430P**  
**D233-0430C**

2  
2

Figure No.

TYPE	LENGTH MM	CATALOGUE NUMBER	WEIGHT KGS
------	-----------	------------------	------------

7

### Atlas Copco SB100

Atlas Copco SBC115, TEX75H / 100H

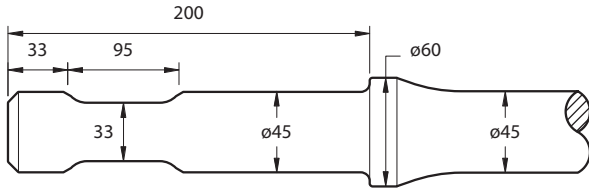

Point	550	D222-0550P	5
Chisel	550	D222-0550C	5

8

### Atlas Copco SB150

Atlas Copco SBC255, TEX110H

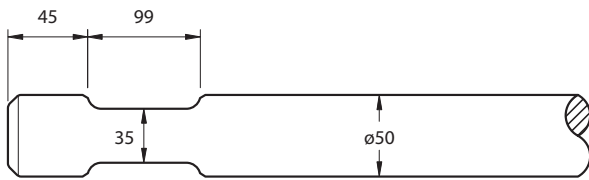

Point	550	D230-0550P	7
Chisel	550	D230-0550C	7

9

### Atlas Copco SB200

Atlas Copco SBC410, TEX180H

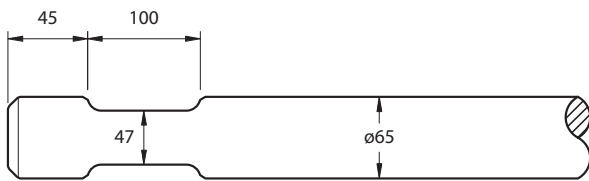

Point	600	D229-0600P	13
Chisel	600	D229-0600C	13

10

### Atlas Copco SB300

Atlas Copco SBC610, SBC650

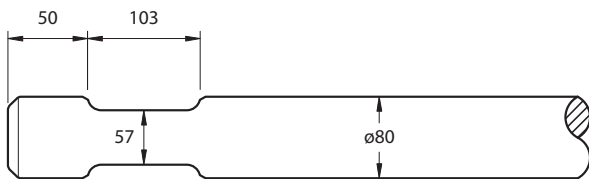

Point	800	D232-0800P	27
Chisel	800	D232-0800C	27
Blunt	800	D232-0800B	27

11

### Atlas Copco SB300 Scaler

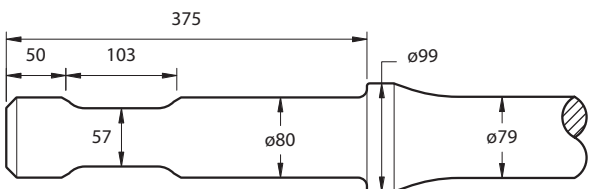

Blunt	800	D235-0800B	28
-------	-----	------------	----

12

### Atlas Copco Tex 250H

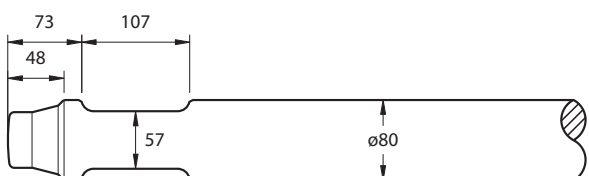

Point	800	D224-0800P	27
Chisel	800	D224-0800C	27

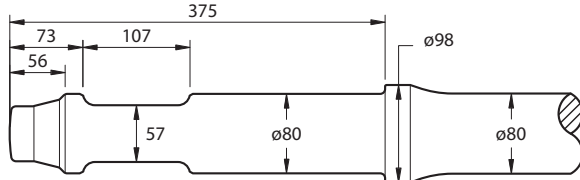

Figure No.

TYPE	LENGTH MM	CATALOGUE NUMBER	WEIGHT KGS
------	-----------	------------------	------------

13

**Atlas Copco Tex 250H Scaler**



Blunt	800	D224-0800B	28
-------	-----	------------	----

14

**Atlas Copco SB450**

Atlas Copco SBC800/850, Tex 400H



Point	840	D231-0840P	43
Chisel	840	D231-0840C	43
Blunt	840	D231-0840B	43

15

**Atlas Copco HBC1100/1700**

Atlas Copco Tex 600H, 700H, 900H

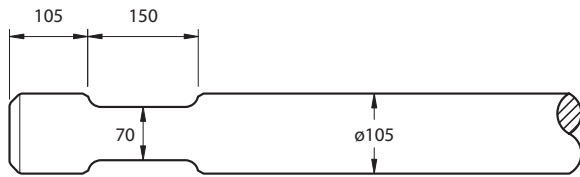

Point	900	D226-0900P	60
Chisel	900	D226-0900C	60
Blunt	900	D226-0900B	60

16

**Atlas Copco HBC2500**

Atlas Copco Tex 1400H

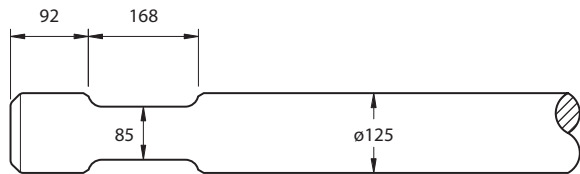

Point	1000	D227-1000P	95
Chisel	1000	D227-1000C	95
Blunt	1000	D227-1000B	95

17

**Atlas Copco HBC4000**

Atlas Copco Tex 1800H/2000H



Point	1100	D228-1100P	119
Chisel	1100	D228-1100C	119
Blunt	1100	D228-1100B	119

18

**Atlas Copco HBC6000**



Point	1500	D234-1500P	245
Chisel	1500	D234-1500P	245
Blunt	1500	D234-1500B	245

Figure No.

TYPE	LENGTH MM	CATALOGUE NUMBER	WEIGHT KGS
------	-----------	------------------	------------

19

### Atlas Copco MB500

Krupp HM350

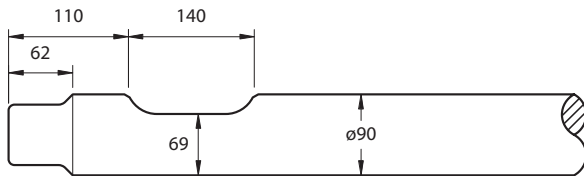

Point  
Chisel

900  
900

D051-0900P  
D051-0900C

36  
36

20

### Atlas Copco MB700/MB800

Krupp HM580, Chicago Pneumatic CP750

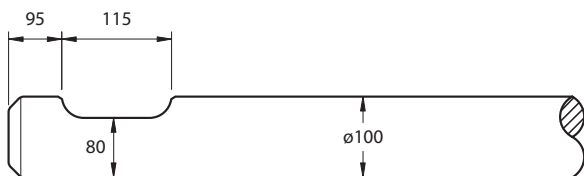

Point  
Chisel  
Blunt

1000  
1000  
1000

D058-1000P  
D058-1000C  
D058-1000B

55  
55  
55

21

### Atlas Copco MB1000

Krupp HM680

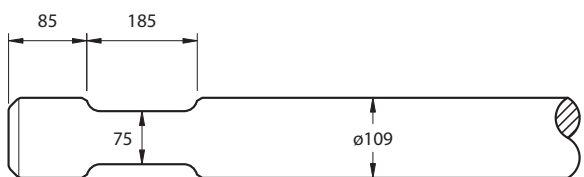

Point  
Chisel  
Blunt

1050  
1050  
1050

D067-1050P  
D067-1050C  
D060-1050B

61  
61  
61

22

### Atlas Copco MB1200

Krupp HM780

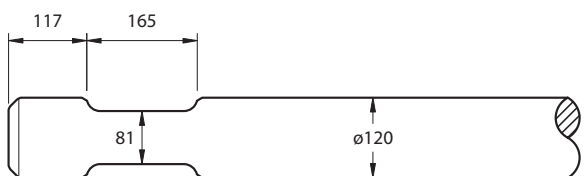

Point  
Chisel  
Blunt

1150  
1150  
1150

D059-1150P  
D059-1150C  
D059-1150B

94  
94  
94

23

### Atlas Copco MB1700

Krupp HM1000



Point  
Chisel  
Blunt

1200  
1200  
1200

D053-1200P  
D053-1200C  
D053-1200B

137  
137  
137

24

### Atlas Copco HB2200

Krupp HM1500, Chicago Pneumatic CP2250

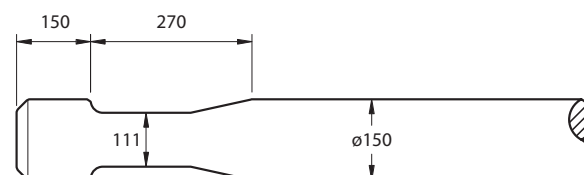

Point  
Chisel  
Blunt

1300  
1300  
1300

D055-1300P  
D055-1300C  
D055-1300B

178  
178  
178

Figure No.

TYPE	LENGTH MM	CATALOGUE NUMBER	WEIGHT KGS
------	-----------	------------------	------------

25

### Atlas Copco HB3000

Krupp HM2300, Chicago Pneumatic CP3050

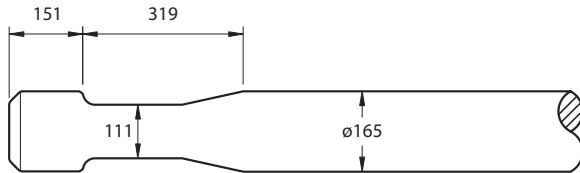

Point	1500	D060-1500P	223
Chisel	1500	D060-1500C	223
Blunt	1500	D060-1500B	223

26

### Atlas Copco HB4200

Krupp HM2600, Chicago Pneumatic CP4250

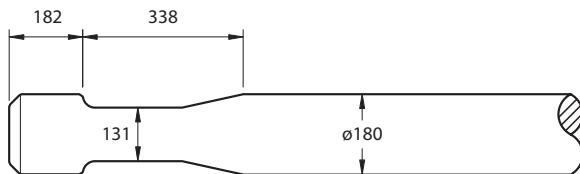

Point	1500	D057-1500P	300
Chisel	1500	D057-1500C	300
Blunt	1500	D057-1500B	300

27

### Atlas Copco HB5800

Krupp HM3000

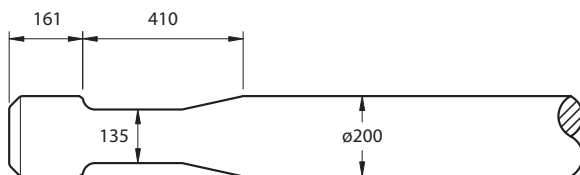

Point	1700	D066-1700P	405
Chisel	1700	D066-1700C	405
Blunt	1700	D066-1700B	405

28

### Atlas Copco HB7000

Krupp HM4000

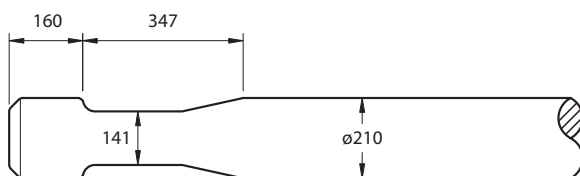

Point	1800	D052-1800P	458
Chisel	1800	D052-1800C	458
Blunt	1800	D052-1800B	458

Figure No.

TYPE	LENGTH MM	CATALOGUE NUMBER	WEIGHT KGS
------	-----------	------------------	------------

29

**Furukawa F1/HB1G**

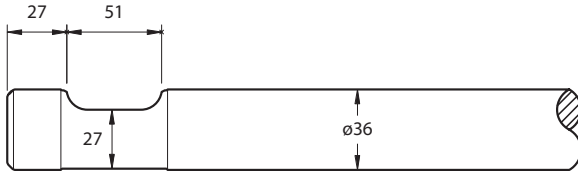

Point	400	D138-0400P	2
Chisel	400	D138-0400C	2

30

**Furukawa F2/HB2G**



Point	450	D139-0450P	3
Chisel	450	D139-0450C	3

31

**Furukawa F3**

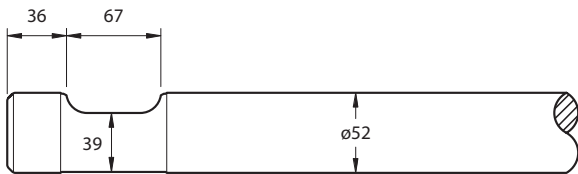

Point	525	D140-0525P	5
Chisel	525	D140-0525C	5

32

**Furukawa F4**

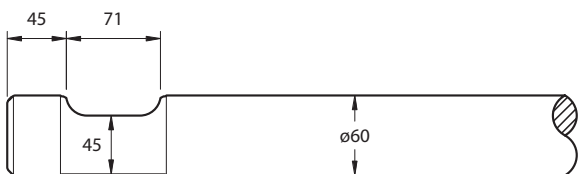

Point	560	D160-0560P	12
Chisel	560	D160-0560C	12

33

**Furukawa F5**

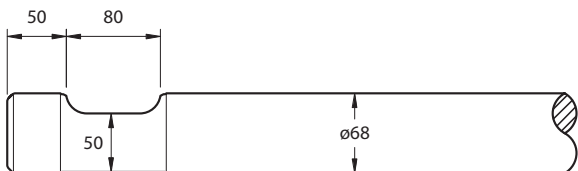

Point	600	D161-0600P	15
Chisel	600	D161-0600C	15

34

**Furukawa F6**

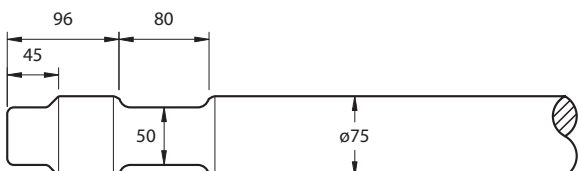

Point	730	D162-0730P	21
Chisel	730	D162-0730C	21

Figure No.

TYPE      LENGTH MM      CATALOGUE NUMBER      WEIGHT KGS

35

**Furukawa F9**

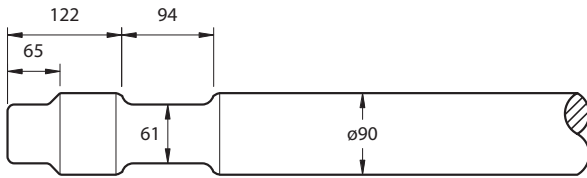

Point 850  
Chisel 850

D163-0850P  
D163-0850C

34  
34

36

**Furukawa F12**

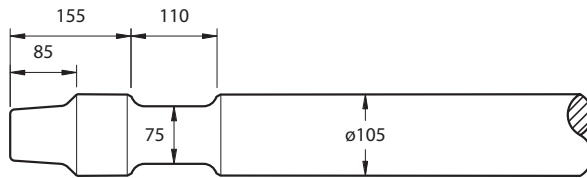

Point 1100  
Chisel 1100  
Blunt 1100

D164-1100P  
D164-1100C  
D164-1100B

72  
72  
72

37

**Furukawa F19**

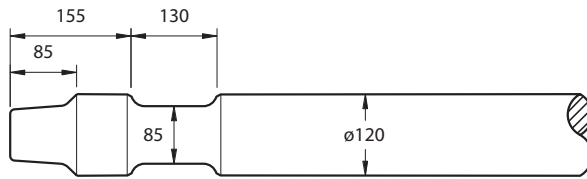

Point 1200  
Chisel 1200  
Blunt 1200

D165-1200P  
D165-1200C  
D165-1200B

97  
97  
97

38

**Furukawa F22**

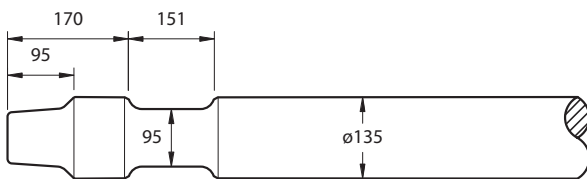

Point 1250  
Chisel 1250  
Blunt 1250

D166-1250P  
D166-1250C  
D166-1250B

125  
125  
125

39

**Furukawa F27**

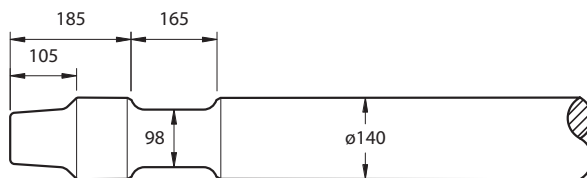

Point 1300  
Chisel 1300  
Blunt 1300

D167-1300P  
D167-1300C  
D167-1300B

136  
136  
136

40

**Furukawa F35**

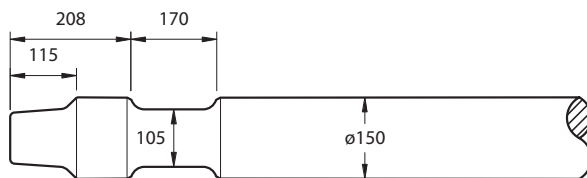

Point 1400  
Chisel 1400  
Blunt 1400

D168-1400P  
D168-1400C  
D168-1400B

192  
192  
192

Figure No.

TYPE	LENGTH MM	CATALOGUE NUMBER	WEIGHT KGS
------	-----------	------------------	------------

41

**Furukawa F45**

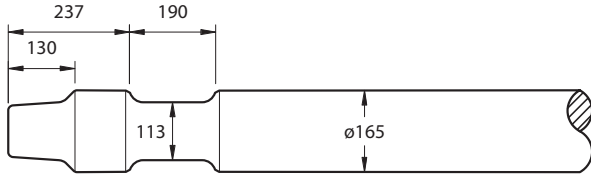

Point	1500	D169-1500P	231
Chisel	1500	D169-1500C	231
Blunt	1500	D169-1500B	231

42

**Furukawa F70**

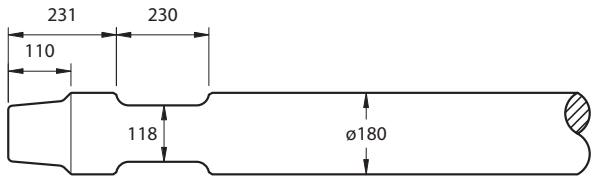

Point	1600	D670-1600P	270
Chisel	1600	D670-1600C	270
Blunt	1600	D670-1600B	270

43

**Furukawa HB1G/ F1**



Point	400	D138-0400P	3
Chisel	400	D138-0400C	3

44

**Furukawa HB2G/F2**

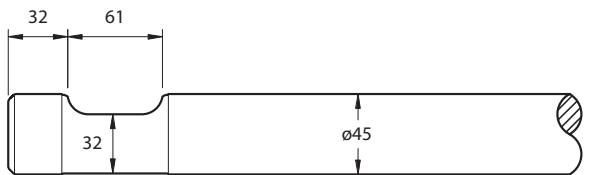

Point	450	D139-0400P	5
Chisel	450	D139-0400C	5

45

**Furukawa HB3G**

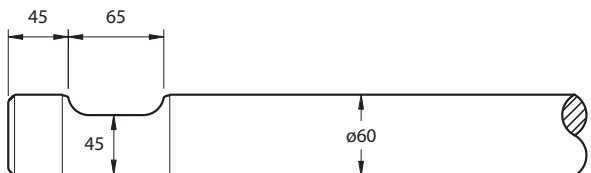

Point	560	D142-0560P	12
Chisel	560	D142-0560C	12

46

**Furukawa HB5G**

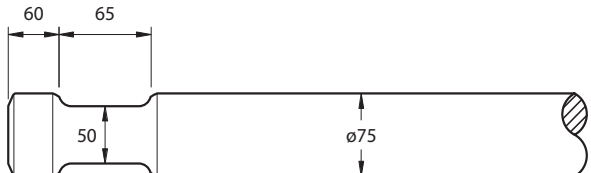

Point	640	D144-0640P	19
Chisel	640	D144-0640C	19

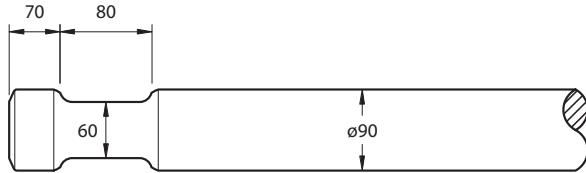

Figure No.

TYPE      LENGTH MM      CATALOGUE NUMBER      WEIGHT KGS

47

**Furukawa HB8G**



Point	750	<b>D146-0750P</b> <b>D146-0750C</b>	30
Chisel	750		30

48

**Furukawa HB10G**

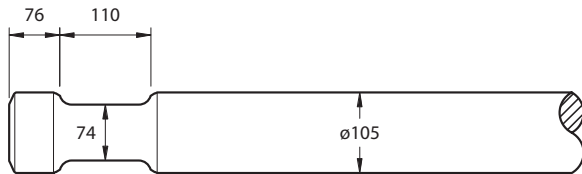

Point	1000	<b>D148-1000P</b> <b>D148-1000C</b>	65
Chisel	1000		65

49

**Furukawa HB15G**



Point	1100	<b>D149-1100P</b> <b>D149-1100C</b>	90
Chisel	1100		90

50

**Furukawa HB20G**

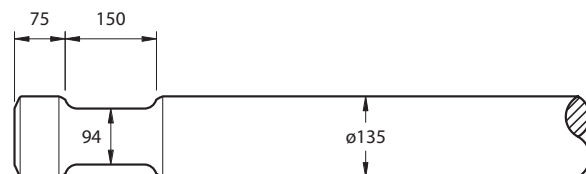

Point	1200	<b>D151-1200P</b> <b>D151-1200C</b>	125
Chisel	1200		125

51

**Furukawa HB30G**

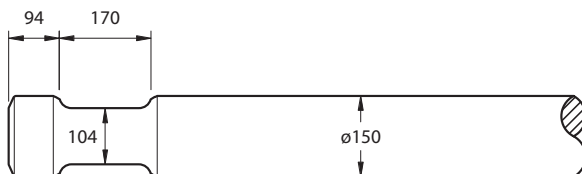

Point	1300	<b>D154-1300P</b> <b>D154-1300C</b>	165
Chisel	1300		165

52

**Furukawa HB40G**

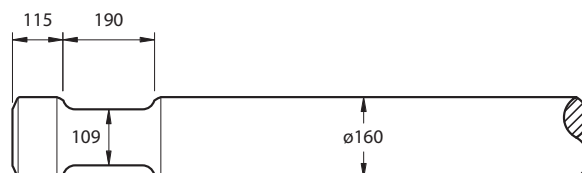

Point	1400	<b>D155-1400P</b> <b>D155-1400C</b>	200
Chisel	1400		200

Figure No.

TYPE      LENGTH MM      CATALOGUE NUMBER      WEIGHT KGS

53

**Hanwoo RHB 301-V**

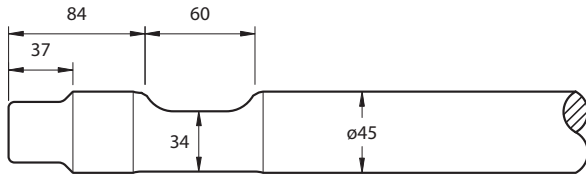

Point 480  
Chisel 480

D550-0480P  
D550-0480C

5  
5

54

**Hanwoo RHB 302/303-V**

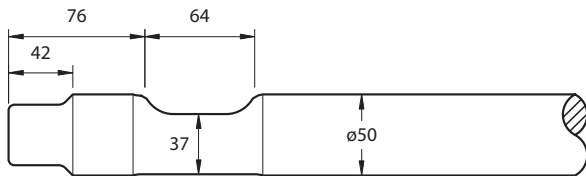

Point 490  
Chisel 490

D551-0490P  
D551-0490C

6  
6

55

**Hanwoo RHB 303**

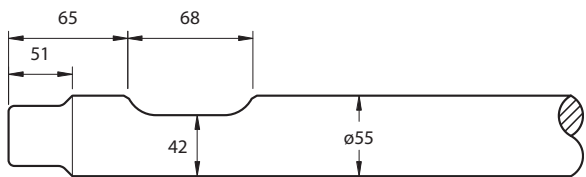

Point 500  
Chisel 500

D552-0500P  
D552-0500C

8  
8

56

**Hanwoo RHB 305-V**

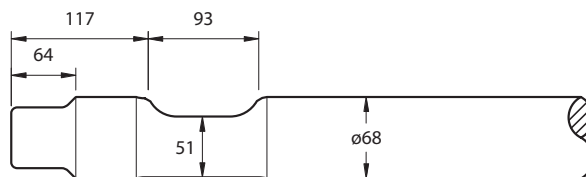

Point 760  
Chisel 760

D553-0760P  
D553-0760C

19  
19

57

**Hanwoo RHB 308-2/309**

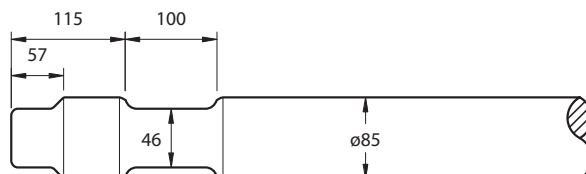

Point 900  
Chisel 900

D564-0900P  
D564-0900C

36  
36

58

**Hanwoo RHB 313-V**

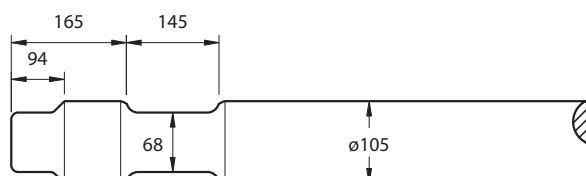

Point 1050  
Chisel 1050

D555-1050P  
D555-1050C

61  
61

Figure No.

TYPE	LENGTH MM	CATALOGUE NUMBER	WEIGHT KGS
------	-----------	------------------	------------

59

**Hanwoo RHB 322-2/325**

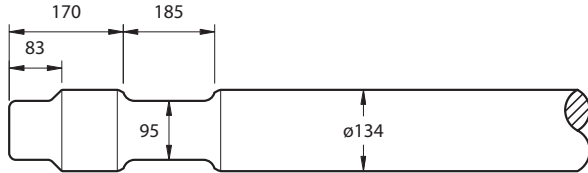

Point	1200	D556-1200P	116
Chisel	1200	D556-1200C	116
Blunt	1050	D556-1050B	104

60

**Hanwoo RHB 328-2/330**

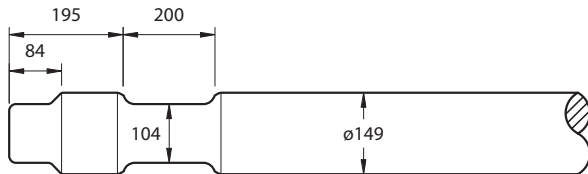

Point	1450	D557-1450P	180
Chisel	1450	D557-1450C	180
Blunt	1300	D557-1300B	164

61

**Hanwoo RHB340**

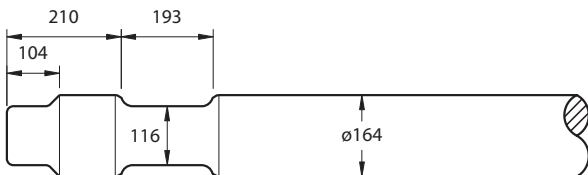

Point	1450	D559-1450P	215
Chisel	1450	D559-1450C	215
Blunt	1300	D559-1300B	195

Figure No.

TYPE      LENGTH MM      CATALOGUE NUMBER      WEIGHT KGS

62

**Indeco HP150**

Indeco UP121/150P, MES121/150, Euroram RM45

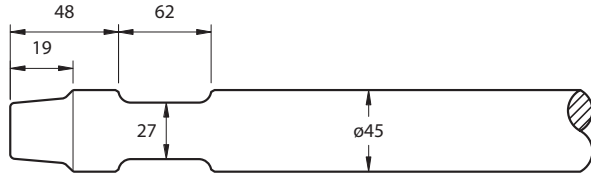

Point  
Chisel

440  
440

D186-0440P  
D186-0440C

4  
4

63

**Indeco HP200**

Indeco UP181/200P, MES180/181/200, Euroram RM48

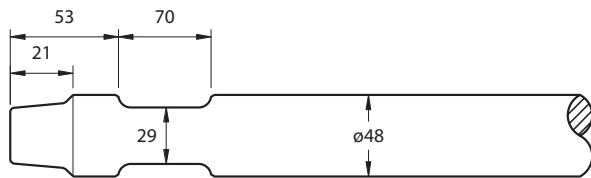

Point  
Chisel

550  
550

D171-0550P  
D171-0550C

6  
6

64

**Indeco HP350**

Indeco UP301/350P/351P, MES 300/301/350/351, Euroram RM56

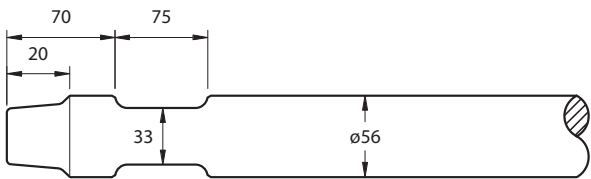

Point  
Chisel

600  
600

D173-0600P  
D173-0600C

10  
10

65

**Indeco HP500**

Indeco HB5, UP462/521/550P, MES 452/462/521/550, Euroram RM65

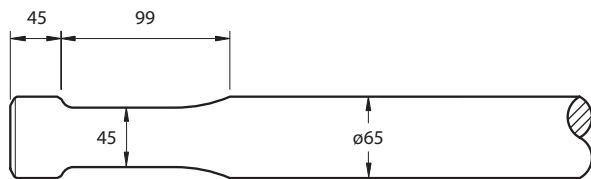

Point  
Chisel

650  
650

D174-0650P  
D174-0650C

15  
15

66

**Indeco HP600**

Indeco UP553, MES 553, Euroram RM75

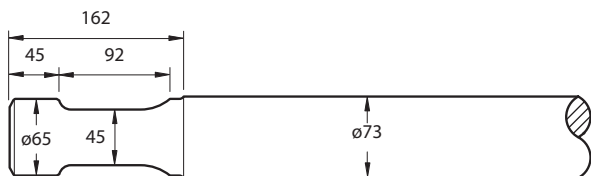

Point  
Chisel

680  
680

D190-0680P  
D190-0680C

19  
19

67

**Indeco HB8**

Euroram RM80

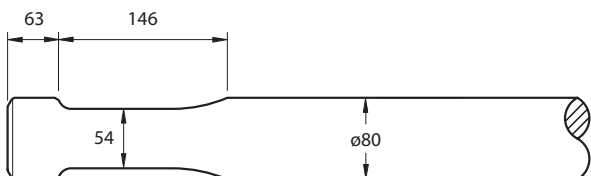

Point  
Chisel  
24

700  
700

D175-0700P  
D175-0700C

24

Figure No.

TYPE      LENGTH MM      CATALOGUE NUMBER      WEIGHT KGS

68

**Indeco HP700**

Indeco UP621/650P, MES 601/621/650

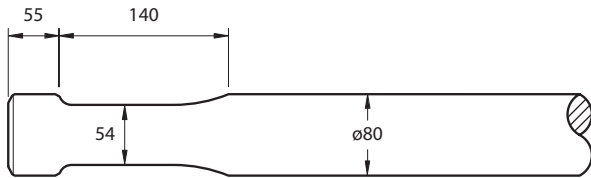

Point	650	<b>D177-0650P</b> <b>D177-0650C</b>	24
Chisel	650		24

69

**Indeco HP900**

Indeco UP900

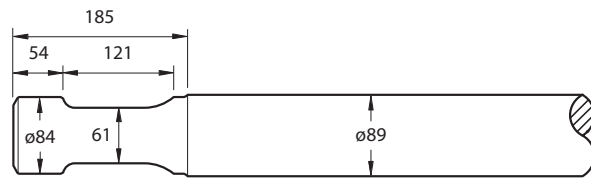

Point	700	<b>D192-0700P</b> <b>D192-0700C</b>	30
Chisel	700		30

70

**Indeco HP1200**

Indeco HB12, UP1200, MES 1200, Euroram RM85/90

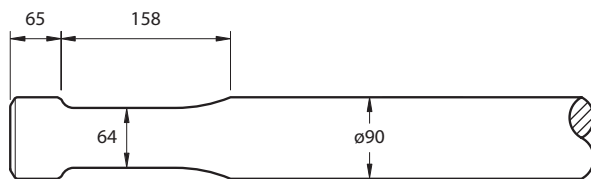

Point	800	<b>D176-0800P</b> <b>D176-0800C</b>	33
Chisel	800		33

71

**Indeco HP1500**

Indeco HB19, UP1500, MES 1500, Euroram RM110

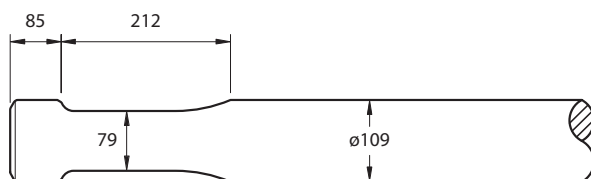

Point	900	<b>D178-0900P</b> <b>D178-0900C</b> <b>D178-0800B</b>	55
Chisel	900		55
Blunt	800		49

72

**Indeco HP1800**

Indeco UP1750, MES 1750/1800, Euroram RM115

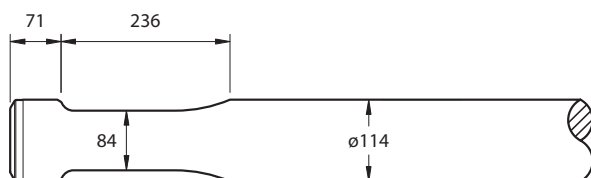

Point	1000	<b>D008-1000P</b> <b>D008-1000C</b> <b>D008-0900B</b>	75
Chisel	1000		75
Blunt	900		68

73

**Indeco HP2000**

Indeco HB27, UP2000, MES 2000, Euroram RM120

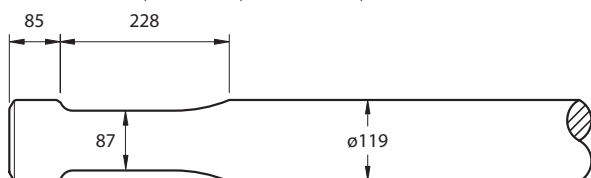

Point	1000	<b>D181-1000P</b> <b>D181-1000C</b> <b>D181-0900B</b>	87
Chisel	1000		87
Blunt	900		78

Figure No.

TYPE	LENGTH MM	CATALOGUE NUMBER	WEIGHT KGS
------	-----------	------------------	------------

74

### Indeco HP2500

Indeco UP2500, MES 2500, Euroram RM130

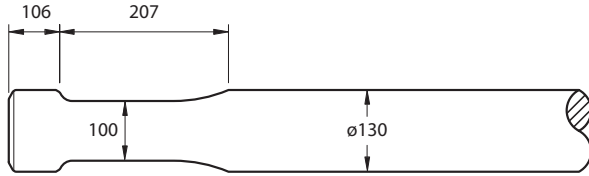

Point	1050	D180-1050P	101
Chisel	1050	D180-1050C	101
Blunt	950	D180-0950B	91

75

### Indeco HP3000

Indeco UP3000, MES 3000, Euroram RM140

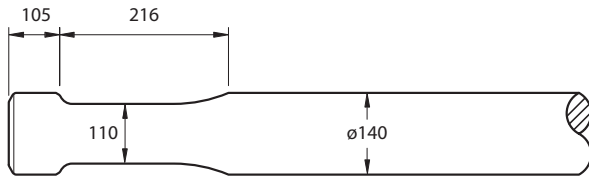

Point	1100	D185-1100P	115
Chisel	1100	D185-1100C	115
Blunt	1000	D185-1000B	115

76

### Indeco HP3500

Indeco UP3500, MES 3500, Euroram RM145

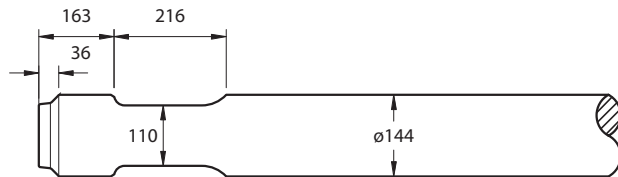

Point	1170	D182-1170P	130
Chisel	1170	D182-1170C	130
Blunt	1070	D182-1070B	119

77

### Indeco HP4000

Indeco UP4000, MES 4000, Euroram RM150

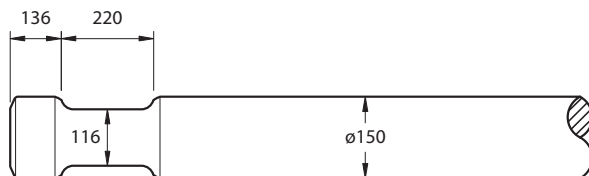

Point	1250	D191-1250P	172
Chisel	1250	D191-1250C	172
Blunt	1150	D191-1150B	158



Figure No.

TYPE	LENGTH MM	CATALOGUE NUMBER	WEIGHT KGS
------	-----------	------------------	------------

78

### Indeco HP5000

Indeco UP5000, MES 5000, Euroram RM160

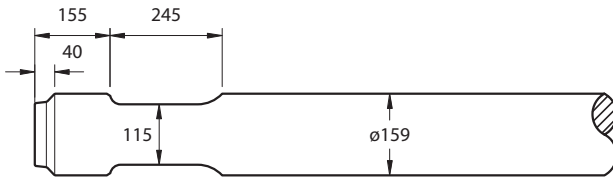

Point	1320	D183-1320P	203
Chisel	1320	D183-1320C	203
Blunt	1170	D183-1170B	180

79

### Indeco HP7000

Indeco UP7000, MES 7000, Euroram RM180

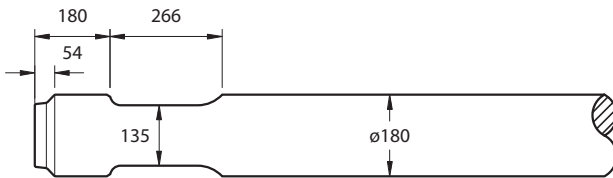

Point	1450	D187-1450P	290
Chisel	1450	D187-1450C	290
Blunt	1300	D187-1300B	260

80

### Indeco HP9000

Indeco UP8500, MES 8500, Euroram RM195

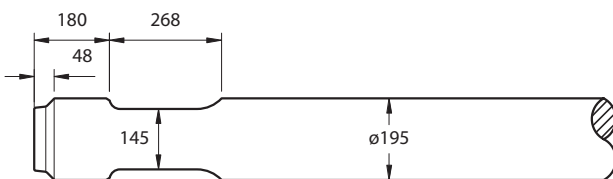

Point	1530	D188-1530P	360
Chisel	1530	D188-1530C	360
Blunt	1380	D188-1380B	325

Figure No.

TYPE	LENGTH MM	CATALOGUE NUMBER	WEIGHT KGS
------	-----------	------------------	------------

81

**Italdem GK 85/86**

Star SH91

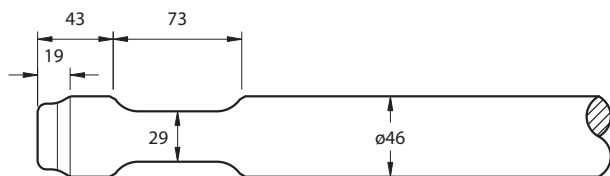

Point	450	D400-0450P	4
Chisel	450	D400-0450C	4

82

**Italdem GK 160/161**

Star SH151

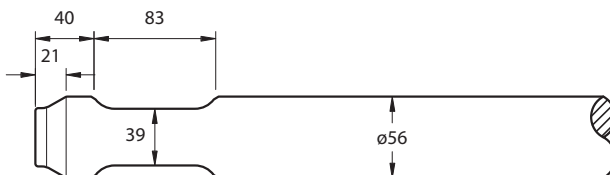

Point	500	D401-0500P	8
Chisel	500	D401-0500C	8

83

**Italdem GK 211**

Star SH200

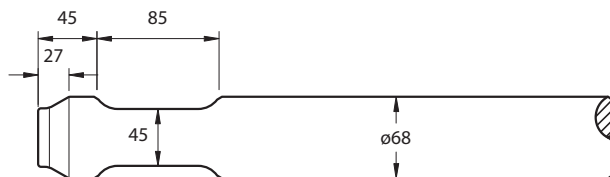

Point	620	D411-0620P	15
Chisel	620	D411-0620C	15

84

**Italdem GK 290/291**

Star SH281

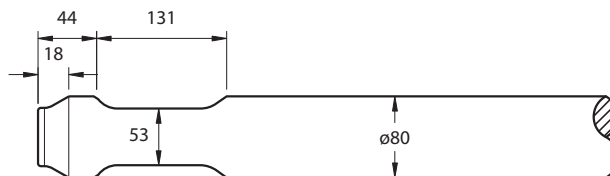

Point	660	D403-0660P	23
Chisel	660	D403-0660C	23

85

**Italdem GK 360/361**

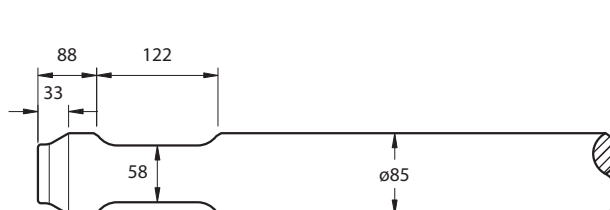

Point	700	D404-0700P	28
Chisel	700	D404-0700C	28

Figure No.

86

### Italdem GK 600/610

Star SH561

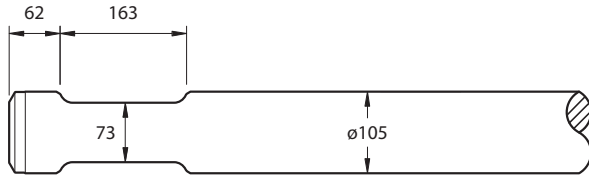

TYPE	LENGTH MM	CATALOGUE NUMBER	WEIGHT KGS
------	-----------	------------------	------------

Point	900	D405-0900P	60
Chisel	900	D405-0900C	60

87

### Italdem GK 950/960

Star SH991

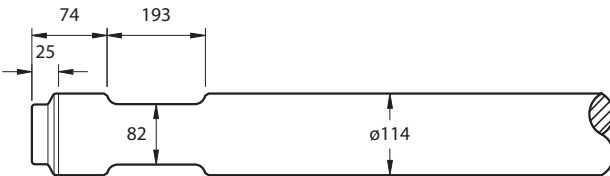

Point	1050	D406-1050P	79
Chisel	1050	D406-1050C	79
Blunt	950	D406-0950B	72

88

### Italdem GK 1350

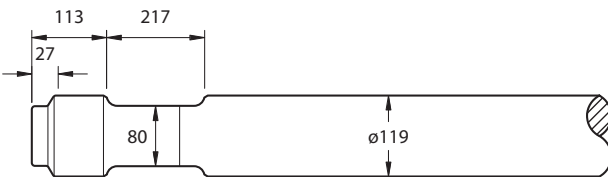

Point	1100	D407-1100P	90
Chisel	1100	D407-1100C	90
Blunt	1000	D407-1000B	82

89

### Italdem GK 1351S

Star SH1402



Point	1150	D412-1150P	94
Chisel	1150	D412-1150C	94
Blunt	1050	D412-1050B	86

90

### Italdem GK 1600

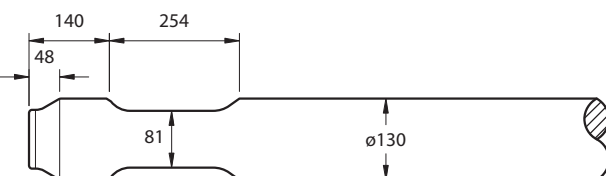

Point	1200	D408-1200P	113
Chisel	1200	D408-1200C	113
Blunt	1100	D408-1100B	104

Figure  
No.

TYPE	LENGTH MM	CATALOGUE NUMBER	WEIGHT KGS
------	--------------	---------------------	---------------

91

**Italdem GK 2400**

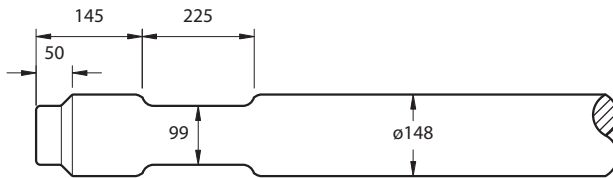

Point	1350	D409-1350P	185
Chisel	1350	D409-1350C	185
Blunt	1200	D409-1200B	165

92

**Italdem GK 3400/3500**

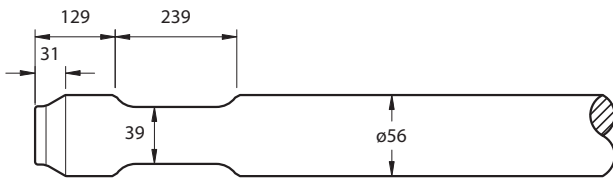

Point	1450	D410-1450P	238
Chisel	1450	D410-1450C	238
Blunt	1300	D410-1300B	214

93

**Italdem GK 3800**

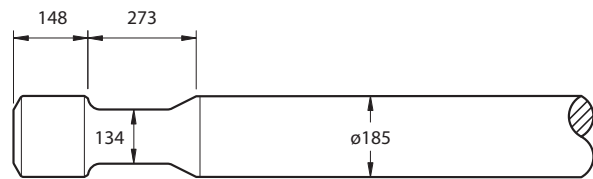

Point	1350	D413-1350P	285
Chisel	1350	D413-1350C	285
Blunt	1300	D413-1250B	265

Figure No.

TYPE      LENGTH MM      CATALOGUE NUMBER      WEIGHT KGS

94

**Krupp HM50/55**

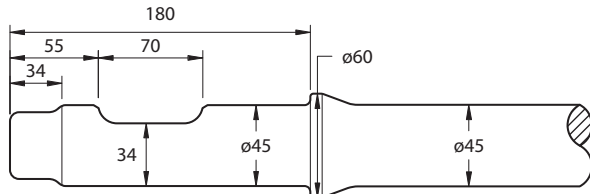

Point 580  
Chisel 580

D031-0580P  
D031-0580C

5  
5

95

**Krupp HM60V**

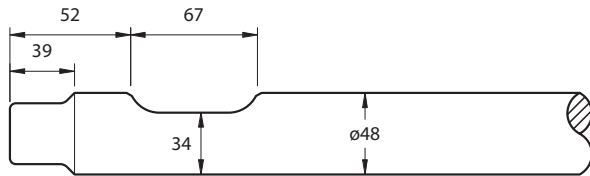

Point 500  
Chisel 500

D054-0500P  
D054-0500C

6  
6

96

**Krupp HM60/75**

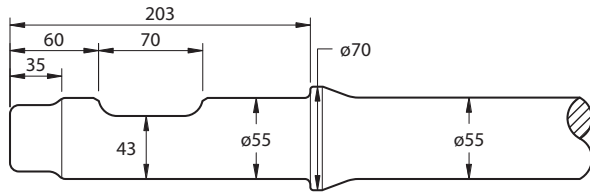

Point 600  
Chisel 600

D032-0600P  
D032-0600C

9  
9

97

**Krupp HM85/90/90V**

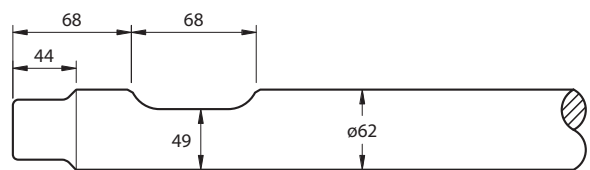

Point 600  
Chisel 600

D033-0600P  
D033-0600C

14  
14

98

**Krupp HM130/140V**

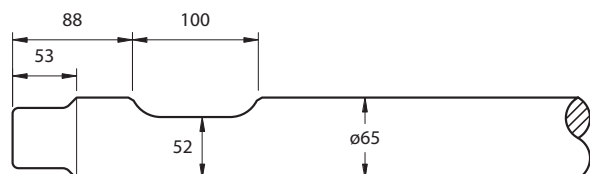

Point 780  
Chisel 780

D035-0780P  
D035-0780C

18  
18

99

**Krupp HM185/190V**

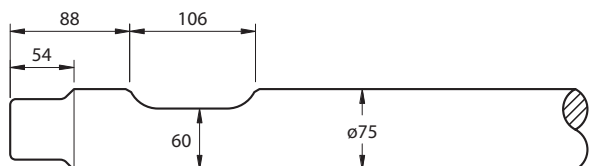

Point 800  
Chisel 800

D036-0800P  
D036-0800C

24  
24

Figure No.

TYPE	LENGTH MM	CATALOGUE NUMBER	WEIGHT KGS
------	-----------	------------------	------------

100

**Krupp HM200**

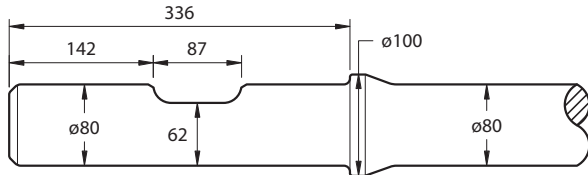

Point	835	D037-0835P	29
Chisel	835	D037-0835C	29

101

**Krupp HM220/230**

Krupp AT220, Chicago Pneumatic CP400/550, Berco BB80

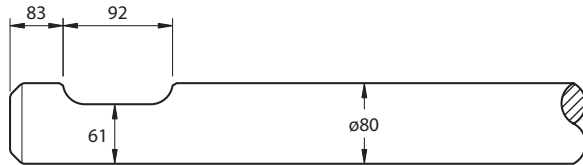

Point	900	D061-0900P	29
Chisel	900	D061-0900C	29

102

**Krupp HM300/301/305**

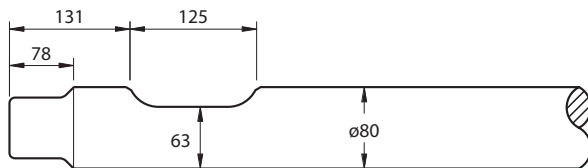

Point	900	D038-0900P	30
Chisel	900	D038-0900C	30

103

**Krupp HM350/350V**

Atlas Copco MB500

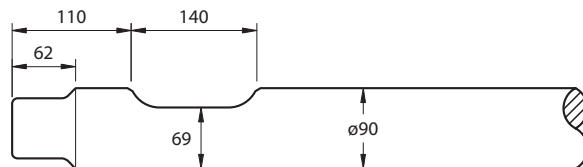

Point	900	D051-0900P	36
Chisel	900	D051-0900C	36

104

**Krupp HM550/560V**

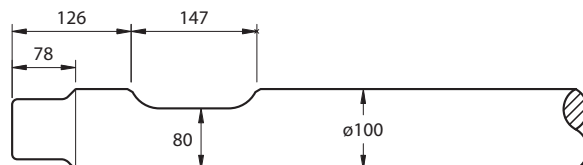

Point	1000	D040-1000P	55
Chisel	1000	D040-1000C	55

105

**Krupp HM580**

Atlas Copco MB800, Chicago Pneumatic CP750

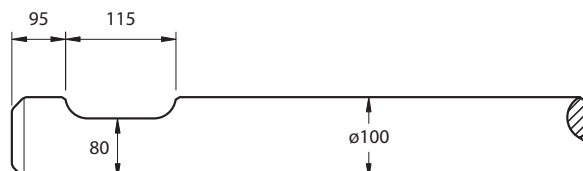

Point	1000	D058-1000P	55
Chisel	1000	D058-1000C	55

Figure No.

TYPE      LENGTH MM      CATALOGUE NUMBER      WEIGHT KGS

106

**Krupp HM600/601**

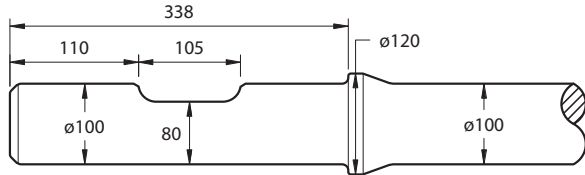

Point 1000 D041-1000P 56  
Chisel 1000 D041-1000C 56

107

**Krupp HM700/701/702/705**

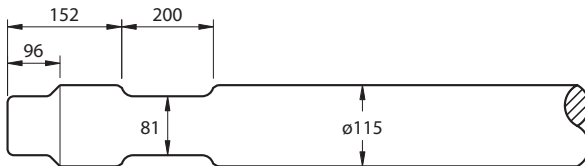

Point 1150 D042-1150P 86  
Chisel 1150 D042-1150C 86  
Blunt 1050 D042-1050B 79

108

**Krupp HM710/720**

Chicago Pneumatic CP1150

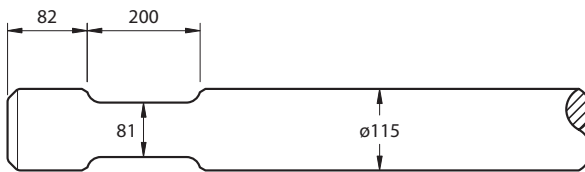

Point 1080 D043-1080P 82  
Chisel 1080 D043-1080C 82  
Blunt 1000 D043-1000B 76

109

**Krupp HM780**

Atlas Copco MB1200



Point 1150 D059-1150P 94  
Chisel 1150 D059-1150C 94  
Blunt 1050 D059-1050B 86  
Blunt 1150 D059-1150B 94

110

**Krupp HM950/960**

Chicago Pneumatic CP1550

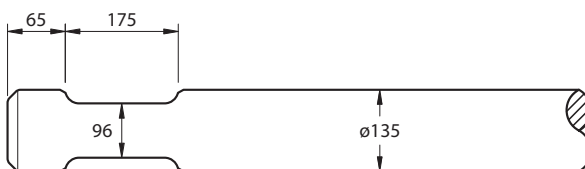

Point 1080 D046-1080P 110  
Point 1350 D046-1350P 137  
Chisel 1080 D046-1080C 110  
Chisel 1350 D046-1350C 137  
Blunt 1080 D046-1080B 110

111

**Krupp HM1000**

Atlas Copco MB1700

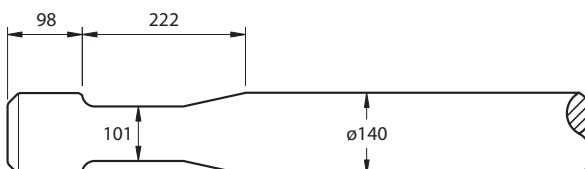

Point 1200 D053-1200P 137  
Chisel 1200 D053-1200C 137  
Blunt 1100 D053-1100B 126

Figure No.

112

### Krupp HM1500MV

Atlas Copco HB2200, Chicago Pneumatic CP2250

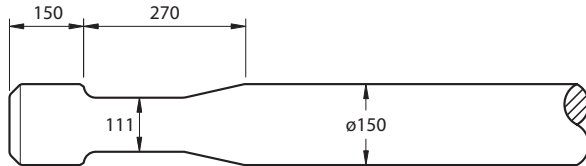

TYPE	LENGTH MM	CATALOGUE NUMBER	WEIGHT KGS
------	-----------	------------------	------------

Point	1300	D055-1300P	178
Chisel	1300	D055-1300C	178
Blunt	1150	D055-1150B	158

113

### Krupp HM2000MV

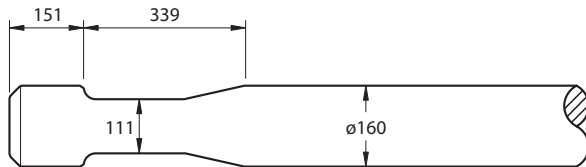

Point	1400	D056-1400P	220
Chisel	1400	D056-1400C	220
Blunt	1250	D056-1250B	197

114

### Krupp HM2100/2300

Atlas Copco HB3000, Chicago Pneumatic CP3050

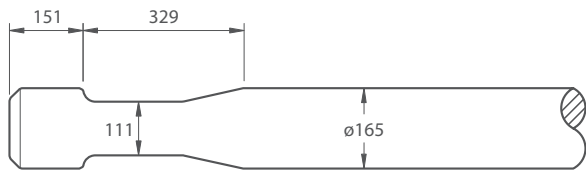

Point	1500	D060-1500P	223
Chisel	1500	D060-1500C	223
Blunt	1350	D060-1350B	201

115

### Krupp HM2500/2600MV

Atlas Copco HB4200, Chicago Pneumatic CP4250

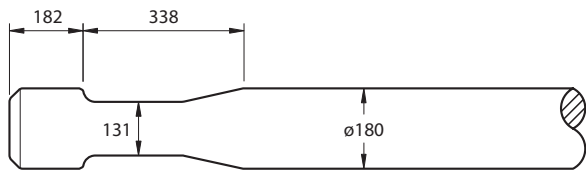

Point	1500	D057-1500P	300
Chisel	1500	D057-1500C	300
Blunt	1350	D057-1350B	270

116

### Krupp HM3000

Atlas Copco HB5800

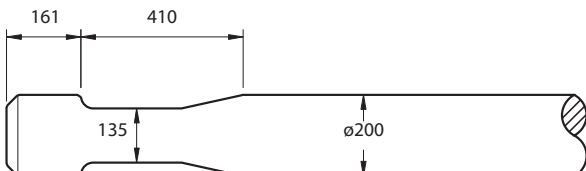

Point	1700	D066-1700P	405
Chisel	1700	D066-1700C	405
Blunt	1500	D066-1500B	358

117

### Krupp HM4000

Atlas Copco HB7000

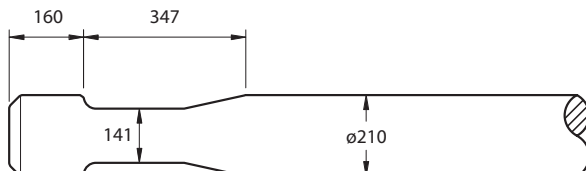

Point	1800	D052-1800P	458
Chisel	1800	D052-1800C	458
Blunt	1600	D052-1600B	408



Figure No.

TYPE	LENGTH MM	CATALOGUE NUMBER	WEIGHT KGS
------	-----------	------------------	------------

118

### Montabert BRH40

Idromeccanica IMI85, Italdem K80, OCM 8, Omal 80, OMD 8, Promove PMV90/P3SH, Star SH40

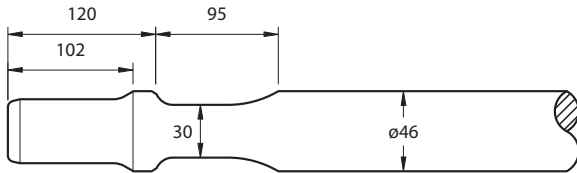

Point	500	D002-0500P	5
Point	700	D002-0700P	7
Chisel	500	D002-0500C	5
Chisel	700	D002-0700C	7

119

### Montabert BRH76/91

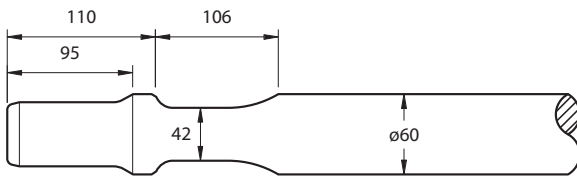

Point	550	D005-0550P	11
Chisel	550	D005-0550C	11

120

### Montabert BRH125

Idromeccanica IMI260, Italdem K270, OCM 25, Omal 270, OMD 30, Promove PMV290/390/P12SH, Star SH280

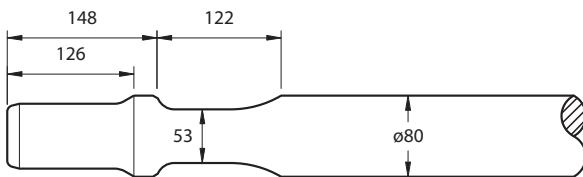

Point	650	D006-0650P	21
Point	760	D006-0760P	24
Point	950	D006-0950P	30
Chisel	650	D006-0650C	21
Chisel	760	D006-0760C	24
Chisel	950	D006-0950C	30

121

### Montabert BRH250/270

Idromeccanica IMI600, Italdem K550, OCM 55, Omal 500, OMD 50, Promove PMV690/P16SH, Star SH560

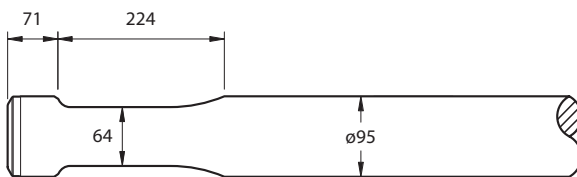

Point	850	D007-0850P	43
Point	1000	D007-1000P	52
Chisel	850	D007-0850C	43
Chisel	1000	D007-1000C	52

122

### Montabert BRH501/570

Idromeccanica IMI1000, Indeco MES1750, Italdem K1000, OCM 100, Omal 1000, OMD 100, Promove PMV 1000/P23SH, Star SH990

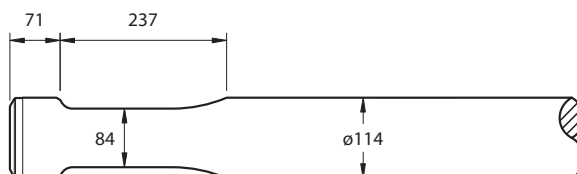

Point	1000	D008-1000P	76
Point	1300	D008-1300P	95
Chisel	1000	D008-1000C	76
Chisel	1300	D008-1300C	95
Blunt	1000	D008-1000B	76

Figure No.

TYPE      LENGTH MM      CATALOGUE NUMBER      WEIGHT KGS

123

### Montabert BRH620

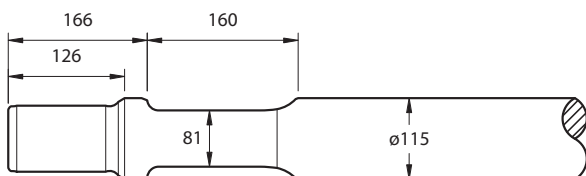

Point	1000	D009-1000P	75
Chisel	1000	D009-1000C	75

124

### Montabert BRH625/900

Italdem K1030, Promove P22, Star SH1200

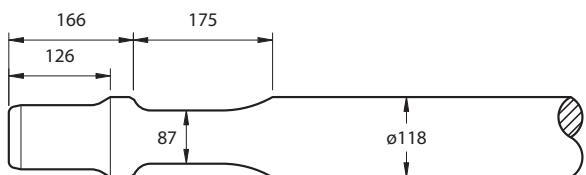

Point	1000	D010-1000P	78
Point	1150	D010-1150P	89
Chisel	1000	D010-1000C	78
Chisel	1150	D010-1150C	89
Blunt	1000	D010-1000B	78

125

### Montabert BRH750

Italdem K1300, OCM130, Promove PMV1390/P27SH, Star SH1400

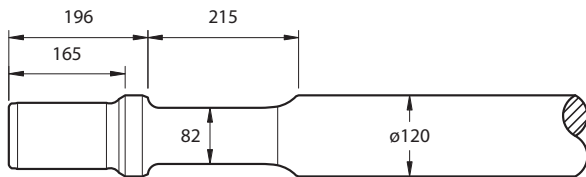

Point	1100	D011-1100P	93
Chisel	1100	D011-1100C	93
Blunt	1000	D011-1000B	85

126

### Montabert 30

Bobcat B300

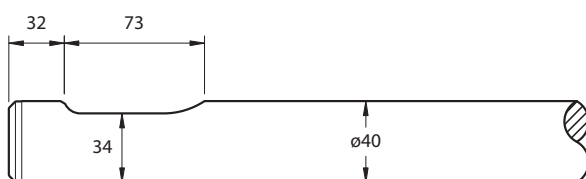

Point	410	D001-0410P	3
Chisel	410	D001-0410C	3

127

### Montabert 50/50SMS

Bobcat B500

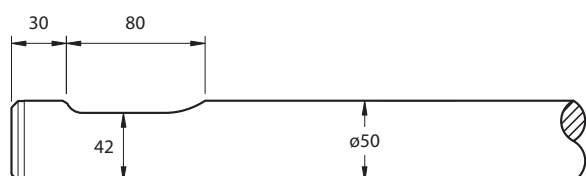

Point	430	D003-0430P	6
Point	630	D003-0630P	8
Chisel	430	D003-0430C	6
Chisel	630	D003-0630C	8

Figure No.

128

### Montabert 70/70SMS

Bobcat B700

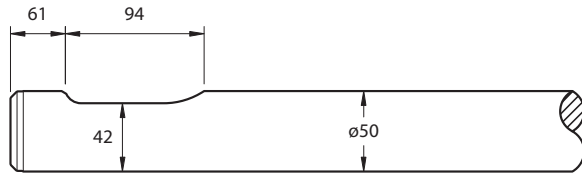

TYPE	LENGTH MM	CATALOGUE NUMBER	WEIGHT KGS
Point	510	D004-0510P	7
Point	710	D004-0710P	9
Chisel	510	D004-0510C	7
Chisel	710	D004-0710C	9

129

### Montabert 85/85SMS/90/90SMS

Bobcat B850/B950

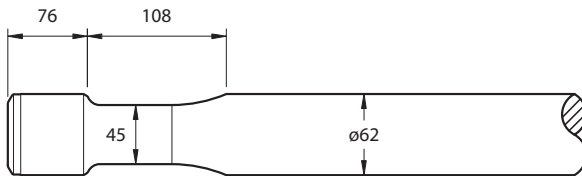

Point	620	D020-0620P	12
Chisel	620	D020-0620C	12

130

### Montabert 125SX

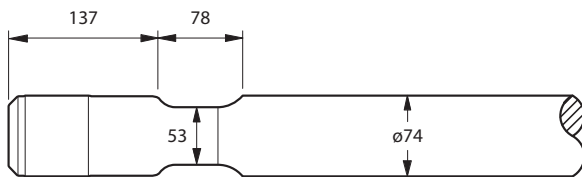

Point	750	D018-0750P	22
Chisel	750	D018-0750C	22

131

### Montabert 140/140SMS/150/150SMS

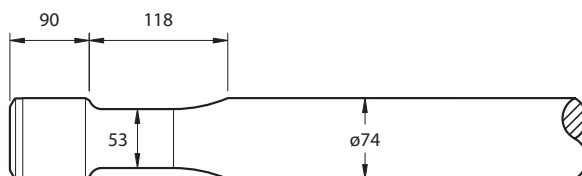

Point	740	D019-0740P	22
Point	950	D019-0950P	28
Chisel	740	D019-0740C	22
Chisel	950	D019-0950C	28

132

### Montabert 300/300MS

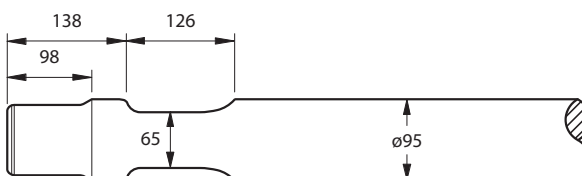

Point	850	D029-0850P	43
Chisel	850	D029-0850C	43

133

### Montabert 700/700SMS

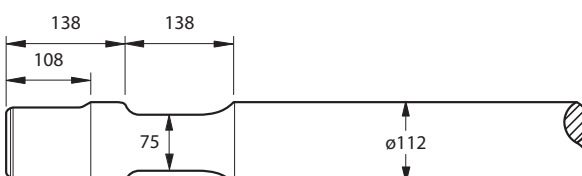

Point	1000	D027-1000P	70
Chisel	1000	D027-1000C	70

Figure No.

TYPE	LENGTH MM	CATALOGUE NUMBER	WEIGHT KGS
------	-----------	------------------	------------

134

**Montabert 900/900MS/BRH625**

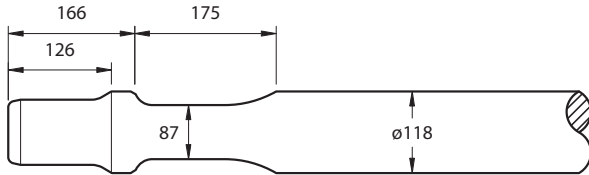

Point	1000	D010-1000P	78
Point	1150	D010-1150P	89
Chisel	1000	D010-1000C	78
Chisel	1150	D010-1150C	89
Blunt	1000	D010-1000B	78

135

**Montabert V1200/V1200MS/V32/V32MS**

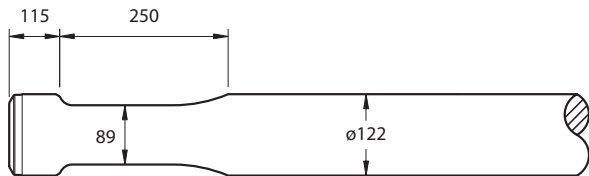

Point	1100	D012-1100P	100
Point	1300	D012-1300P	118
Chisel	1100	D012-1100C	100
Chisel	1300	D012-1300C	118
Blunt	1100	D012-1100B	100

136

**Montabert Silver Clip 08 (SC08)**

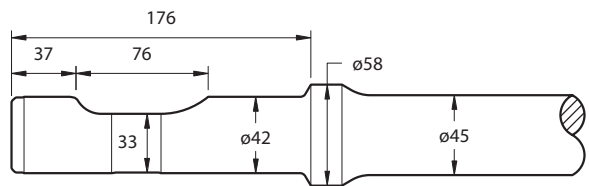

Point	455	D707-0455P	4
Chisel	455	D707-0475C	4
Pyramid Pt	455	D707-0455PP	4

137

**Montabert Silver Clip 12 (SC12)**

Bobcat 580

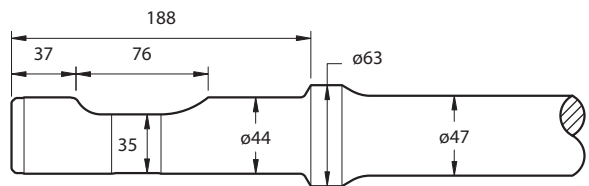

Point	475	D700-0475P	5
Chisel	475	D700-0475C	5
Pyramid Pt	475	D700-0475PP	5

138

**Montabert Silver Clip 16 (SC16)**

Bobcat 680

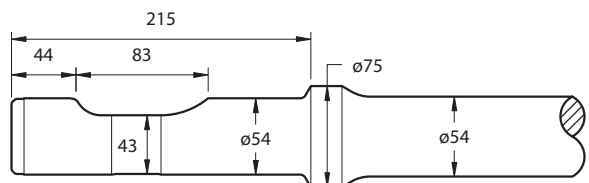

Point	550	D703-0550P	9
Chisel	550	D703-0550C	9
Pyramid Pt	550	D703-0550PP	9

139

**Montabert Silver Clip 22 (SC22)**

Bobcat 880

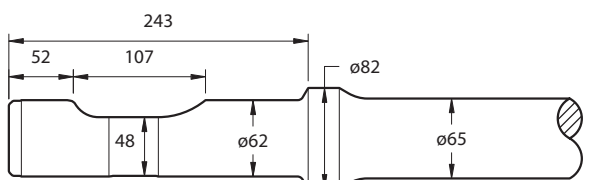

Point	580	D704-0580P	13
Chisel	580	D704-0580C	13
Pyramid Pt	580	D704-0580PP	13

Figure No.

140

### Montabert Silver Clip 28 (SC28)

Bobcat 980

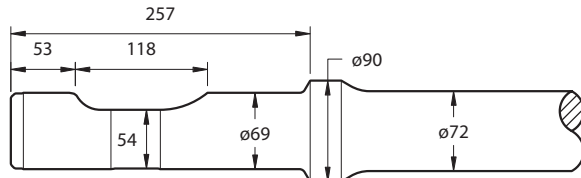

TYPE	LENGTH MM	CATALOGUE NUMBER	WEIGHT KGS
------	-----------	------------------	------------

Point	620	D705-0620P	18
Chisel	620	D705-0620C	18
Pyramid Pt	620	D705-0620PP	18

141

### Montabert V32/V32MS/V1200/V1600

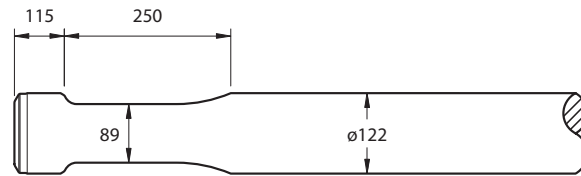

Point	1100	D012-1100P	100
Point	1300	D012-1300P	118
Chisel	1100	D012-1100C	100
Chisel	1300	D012-1300C	118
Blunt	1100	D012-1100B	100

142

### Montabert V43

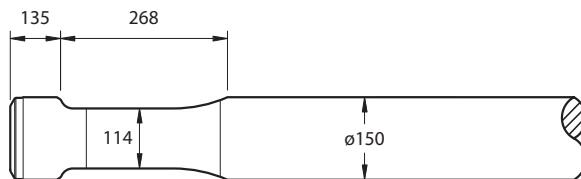

Point	1250	D014-1250P	172
Chisel	1250	D014-1250C	172
Blunt	1100	D014-1100B	152

143

### Montabert V53

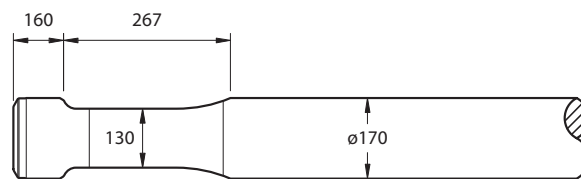

Point	1400	D016-1400P	230
Chisel	1400	D016-1400C	230
Blunt	1250	D016-1250B	206

Figure No.

144

**MSB MS200**

Wimmer W-220

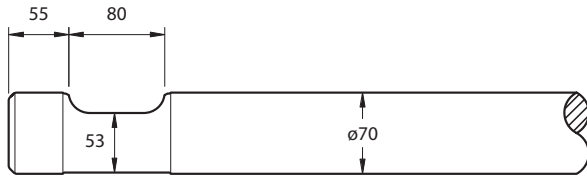

TYPE

LENGTH  
MM

CATALOGUE  
NUMBER

WEIGHT  
KGS

Point  
Chisel

680  
680

D501-0680P  
D501-0680C

20  
20

145

**MSB MS250**

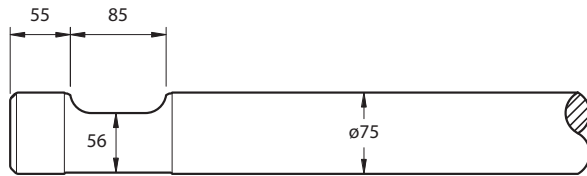

Point  
Chisel

700  
700

D502-0700P  
D502-0700C

21  
21

146

**MSB MS300**

Wimmer W-330

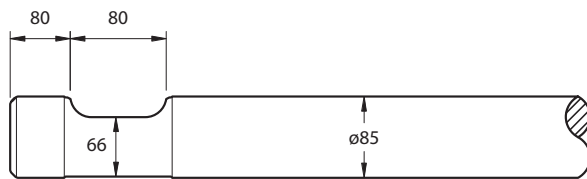

Point  
Chisel

790  
790

D503-0790P  
D503-0790C

28  
28

147

**MSB MS400**

Wimmer W-440

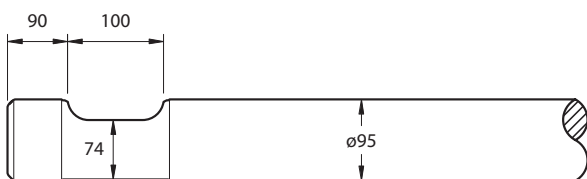

Point  
Chisel

920  
920

D504-0920P  
D504-0920C

48  
48

148

**MSB MS450**

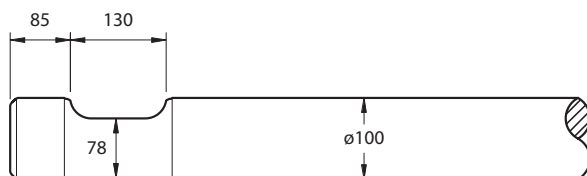

Point  
Chisel

920  
920

D517-0920P  
D517-0920C

52  
52

Figure No.

149

### MSB MS500

Wimmer W-550

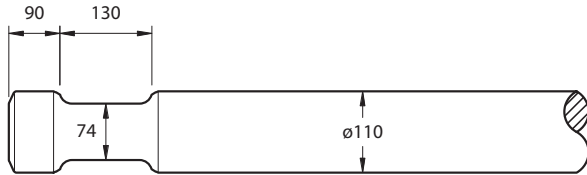

TYPE

LENGTH  
MM

CATALOGUE  
NUMBER

WEIGHT  
KGS

Point  
Chisel

1050  
1050

D505-1050P  
D505-1050C

64  
64

150

### MSB MS600 (New)

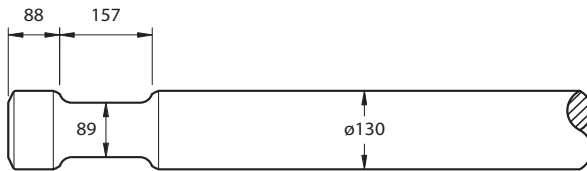

Point  
Chisel  
Blunt

1200  
1200  
1100

D507-1200P  
D507-1200C  
D507-1100B

111  
111  
102

151

### MSB MS700

Wimmer W-770

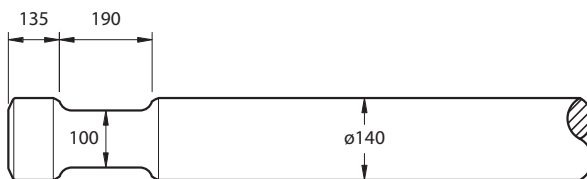

Point  
Chisel  
Blunt

1200  
1200  
1100

D509-1200P  
D509-1200C  
D509-1100B

137  
137  
126

152

### MSB MS800

Wimmer W-880

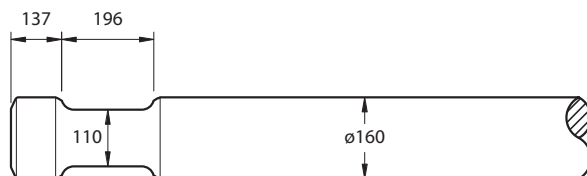

Point  
Chisel  
Blunt

1400  
1400  
1250

D511-1400P  
D511-1400C  
D511-1250B

206  
206  
184

153

### MSB MS900

Wimmer W-990

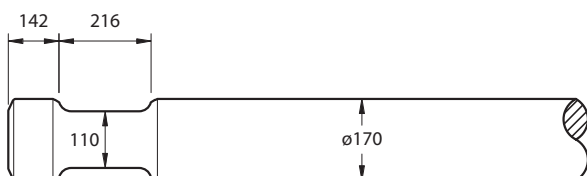

Point  
Chisel  
Blunt

1450  
1450  
1300

D512-1450P  
D512-1450C  
D512-1300B

240  
240  
215

Figure No.

TYPE	LENGTH MM	CATALOGUE NUMBER	WEIGHT KGS
------	-----------	------------------	------------

154

### MSB Saga 1000

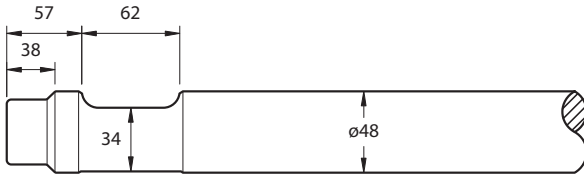

Point	500	D513-0500P	6
Chisel	500	D513-0500C	6

155

### MSB Saga 1500

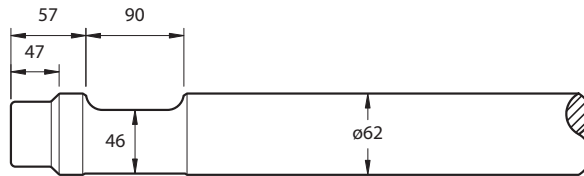

Point	580	D514-0580P	11
Chisel	580	D514-0580C	11

156

### MSB Saga 2000

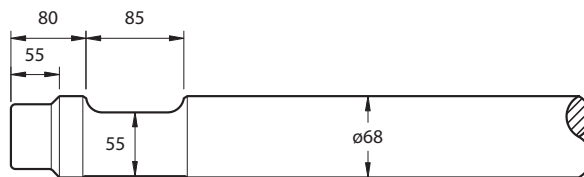

Point	630	D515-0630P	15
Chisel	630	D515-0630C	15

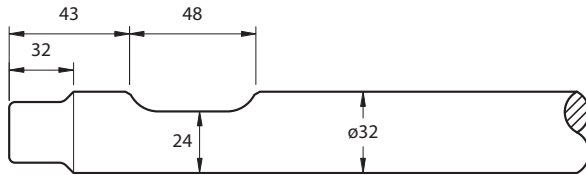

Figure No.

TYPE	LENGTH MM	CATALOGUE NUMBER	WEIGHT KGS
------	-----------	------------------	------------

157

**NPK E-102**



Point	390	<b>D131-0390P</b>	2
Chisel	390	<b>D131-0390C</b>	2

158

**NPK E-106**

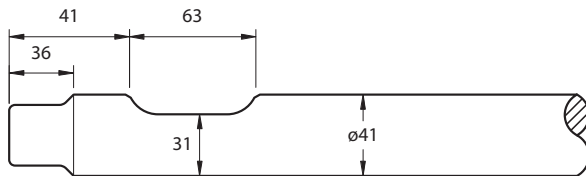

Point	410	<b>D134-0410P</b>	4
Chisel	410	<b>D134-0410C</b>	4

159

**NPK E-200**

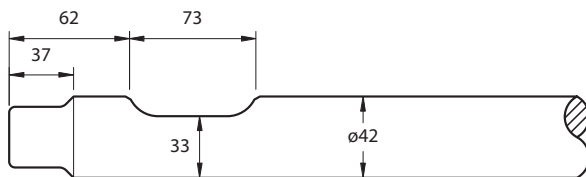

Point	500	<b>D630-0500P</b>	5
Chisel	500	<b>D630-0500C</b>	5

160

**NPK E-201**

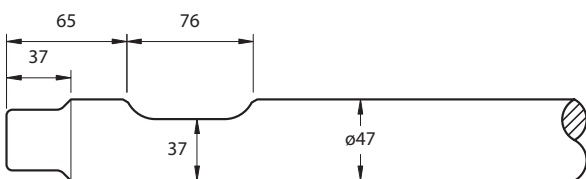

Point	550	<b>D631-0550P</b>	6
Chisel	550	<b>D631-0550C</b>	6

161

**NPK E-202**

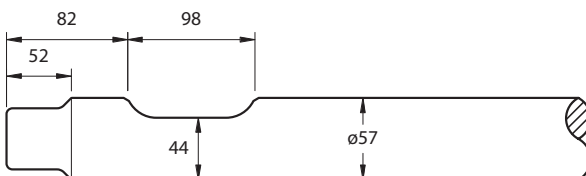

Point	650	<b>D632-0650P</b>	9
Chisel	650	<b>D632-0650C</b>	9

162

**NPK E-203**

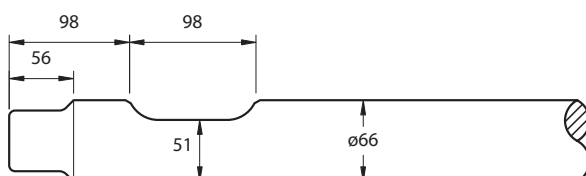

Point	700	<b>D633-0700P</b>	17
Chisel	700	<b>D633-0700C</b>	17

Figure No.

TYPE	LENGTH MM	CATALOGUE NUMBER	WEIGHT KGS
------	-----------	------------------	------------

163

**NPK E-204**

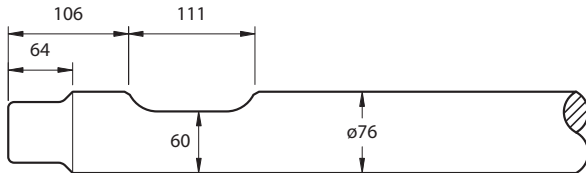

Point	750	<b>D634-0750P</b>	22
Chisel	750	<b>D634-0750C</b>	22

164

**NPK E-205**

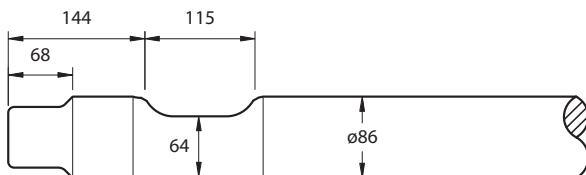

Point	850	<b>D635-0850P</b>	31
Chisel	850	<b>D635-0850C</b>	31

165

**NPK E-206**

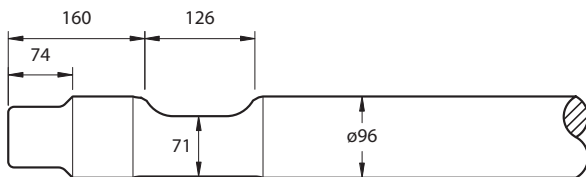

Point	940	<b>D638-0940P</b>	49
Chisel	940	<b>D638-0940C</b>	49

166

**NPK E-207**

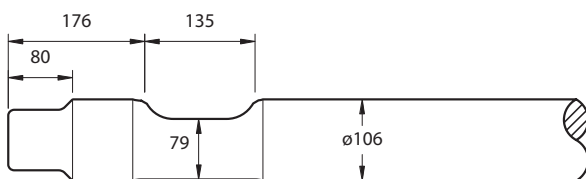

Point	950	<b>D636-0950P</b>	63
Chisel	950	<b>D636-0950C</b>	63

167

**NPK E-208A**

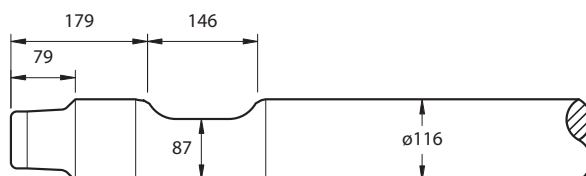

Point	1050	<b>D637-1050P</b>	81
Chisel	1050	<b>D637-1050C</b>	81

168

**NPK E-210**

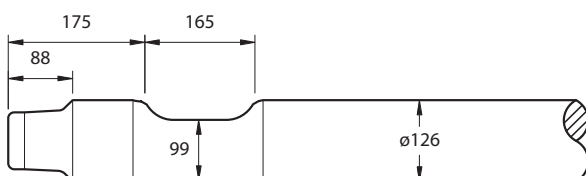

Point	1100	<b>D135-1100P</b>	93
Chisel	1100	<b>D135-1100C</b>	93

Figure No.

TYPE      LENGTH MM      CATALOGUE NUMBER      WEIGHT KGS

169

**NPK E-213**

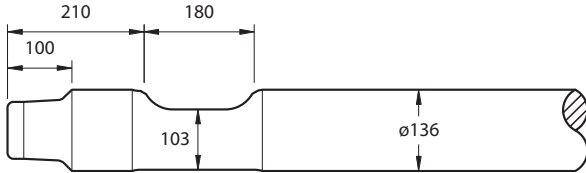

Point	1200	D126-1200P	121
Chisel	1200	D126-1200C	121
Blunt	1100	D126-1100B	111

170

**NPK E-216**

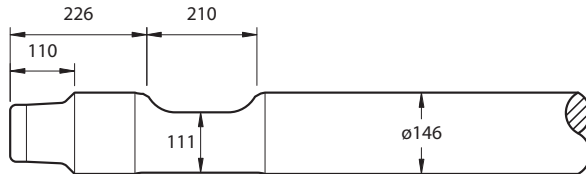

Point	1300	D136-1300P	145
Chisel	1300	D136-1300C	145
Blunt	1150	D136-1150B	129

171

**NPK E-220**

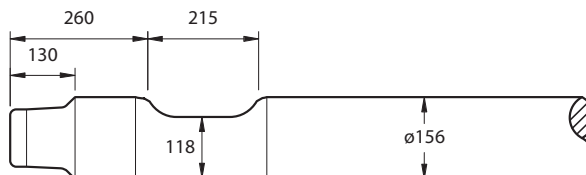

Point	1350	D127-1350P	183
Chisel	1350	D127-1350C	183
Blunt	1200	D127-1200B	163

172

**NPK E-225**

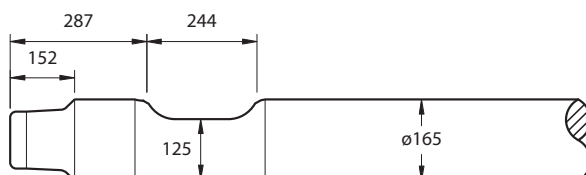

Point	1525	D137-1525P	227
Chisel	1525	D137-1525C	227
Blunt	1350	D137-1350B	201

173

**NPK E-240A**

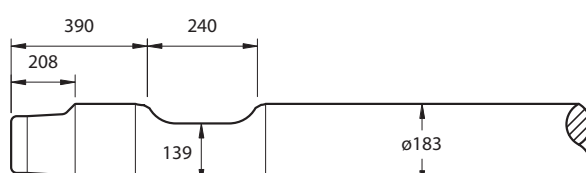

Point	1700	D132-1700P	360
Chisel	1700	D132-1700P	360
Blunt	1500	D132-1500B	318

174

**NPK GH10**

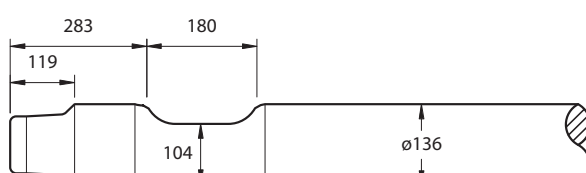

Point	1200	D639-1200P	115
Chisel	1200	D639-1200C	115
Blunt	1100	D639-1100B	105

Figure No.

175

### NPK H-06X

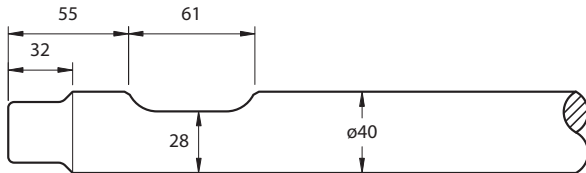

TYPE	LENGTH MM	CATALOGUE NUMBER	WEIGHT KGS
Point	470	D101-0470P	4
Chisel	470	D101-0470C	4

176

### NPK H-08XA

Arrowhead 2T

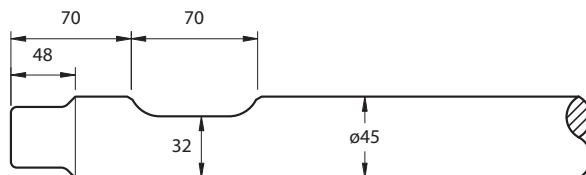

Point	480	D102-0480P	5
Chisel	480	D102-0480C	5

177

### NPK H-1XA

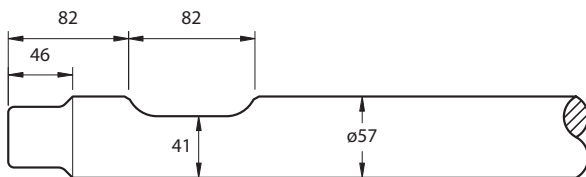

Point	580	D103-0580P	10
Chisel	580	D103-0580C	10

178

### NPK H-2XA/H-2XE

Arrowhead 4T

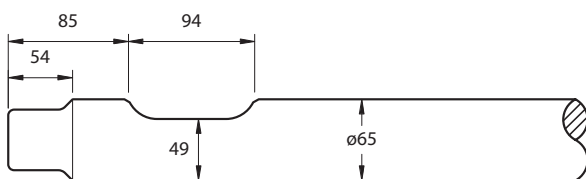

Point	620	D104-0620P	15
Chisel	620	D104-0620C	15

179

### NPK H-3XA/H-3XE

Arrowhead 6T

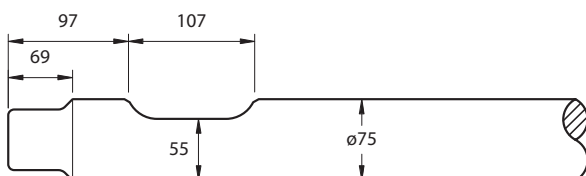

Point	710	D105-0710P	21
Chisel	710	D105-0710C	21

180

### NPK H-4X

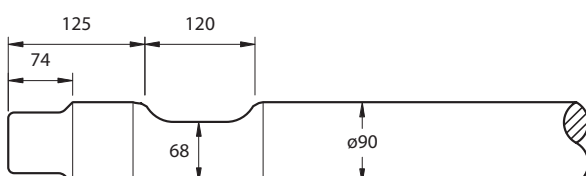

Point	780	D106-0780P	32
Chisel	780	D105-0780C	32

Figure No.

181

**NPK H-6XA**

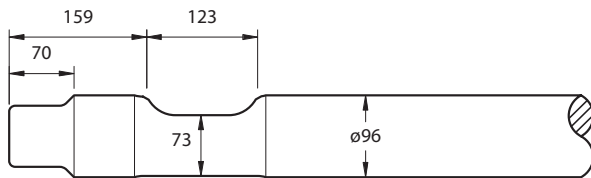

TYPE	LENGTH MM	CATALOGUE NUMBER	WEIGHT KGS
Point	920	D109-0920P	48
Chisel	920	D109-0920C	48

182

**NPK H-7XA**

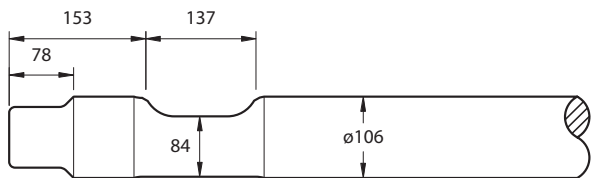

Point	930	D110-0930P	57
Chisel	930	D110-0930C	57

183

**NPK H-8XA**

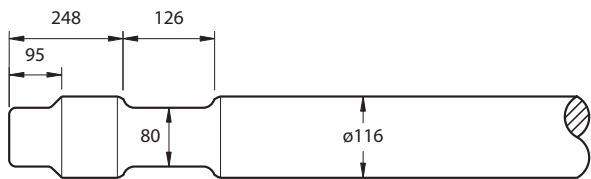

Point	1015	D111-1015P	74
Chisel	1015	D111-1015C	74

184

**NPK H-10XB/H-10XE**

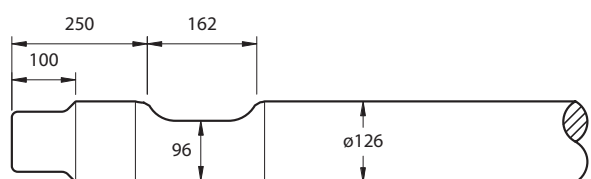

Point	1100	D114-1100P	93
Chisel	1100	D114-1100C	93
Blunt	1000	D114-1000B	85

185

**NPK H-12XE**

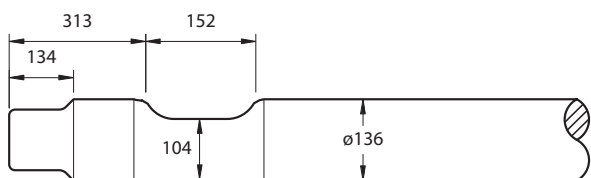

Point	1200	D115-1200P	115
Chisel	1200	D115-1200C	115
Blunt	1100	D115-1100B	106

Figure  
No.

186

### Rammer S18/ Piccolo

Kubota KXB300/350, Volvo HB80

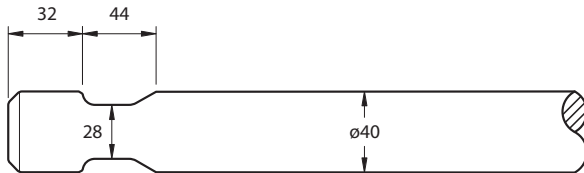

TYPE	LENGTH MM	CATALOGUE NUMBER	WEIGHT KGS
------	--------------	---------------------	---------------

Point	400	D070-0400P	4
Chisel	400	D070-0400C	4

187

### Rammer S21

Caterpillar H45FT, Bobcat 1750, Case CB140, JCB HM160,  
Kubota KXB400/BTB400, O&K H32, Volvo HB130

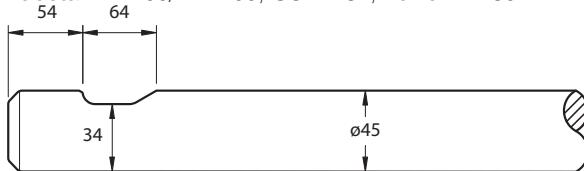

Point	480	D071-0480P	5
Point	560	D071-0560P	6
Chisel	480	D071-0480C	5
Chisel	560	D071-0560C	6

188

### Rammer S22

Caterpillar H50FT, Case CB200, Kubota KXB450, O&K H45, Volvo HB200

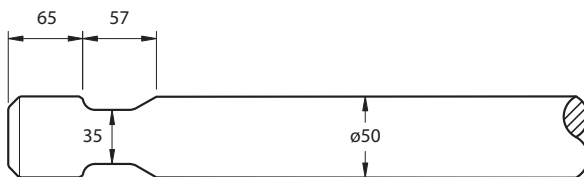

Point	530	D091-0530P	8
Point	600	D091-0600P	9
Chisel	530	D091-0530C	8
Chisel	600	D091-0600C	9

189

### Rammer S23

Caterpillar H63/H63FT, Case CB370, JCB HM260, Kubota KXB500, O&K H65, Volvo HB300

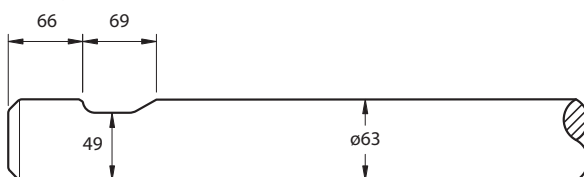

Point	680	D073-0680P	15
Point	780	D073-0780P	17
Chisel	680	D073-0680C	15
Chisel	780	D073-0780C	17

190

### Rammer S25

Caterpillar H70/H70FT, Case CB620, JCB HM360, Kubota KXB600, O&K H85, Volvo HB440

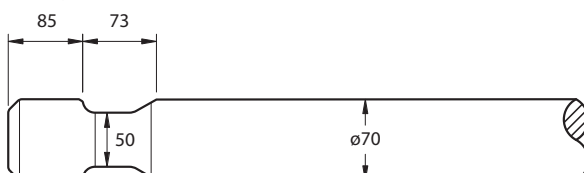

Point	730	D075-0730P	20
Point	830	D075-0830P	23
Chisel	730	D075-0730C	20
Chisel	830	D075-0830C	23

191

### Rammer S26

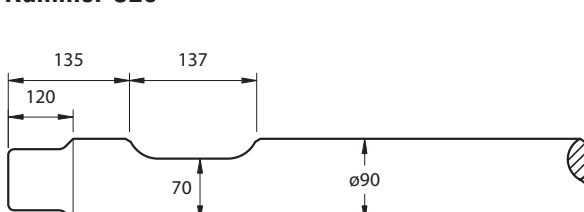

Point	850	D076-0850P	35
Chisel	850	D076-0850C	35

Figure No.

192

### Rammer S27

Caterpillar H90/H90FT, Case CB735, JCB HM550, O&K H120, Volvo HB600

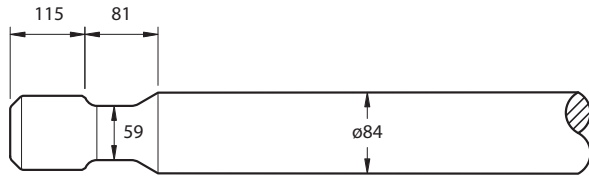

TYPE	LENGTH MM	CATALOGUE NUMBER	WEIGHT KGS
Point	840	D087-0840P	34
Chisel	840	D087-0840C	34

193

### Rammer S29

Caterpillar H100/H100FT, Case CB1150, JCB HM850, O&K H150, Volvo HB800

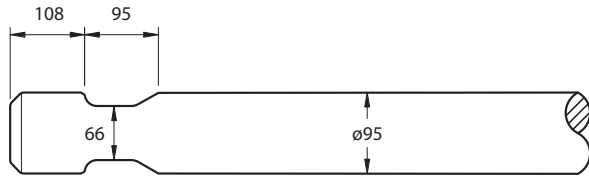

Point	900	D090-0900P	47
Chisel	900	D090-0900C	47

194

### Rammer S52

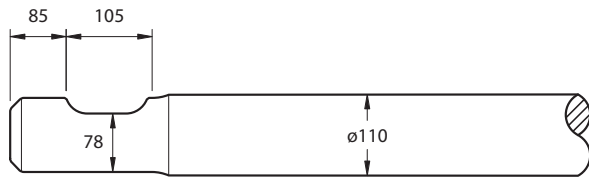

Point	900	D077-0900P	55
Chisel	900	D077-0900C	55

195

### Rammer S54

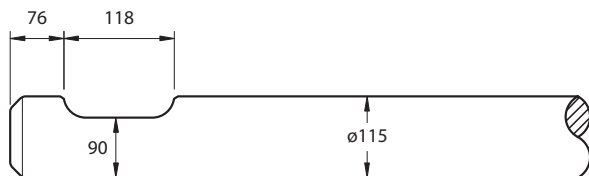

Point	1050	D078-1050P	80
Chisel	1050	D078-1050C	80

196

### Rammer S55/E66

Caterpillar H120s, Case CB2850, JCB HM1350, O&K H260

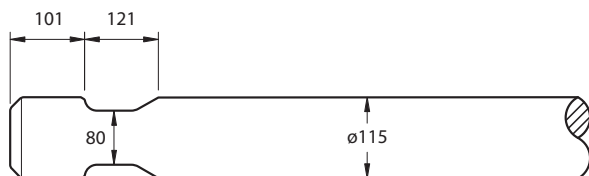

Point	1050	D079-1050P	80
Point	1150	D079-1150C	88
Chisel	1050	D079-1050C	80
Chisel	1150	D079-1150C	88
Blunt	950	D079-0950B	73

197

### Rammer S56

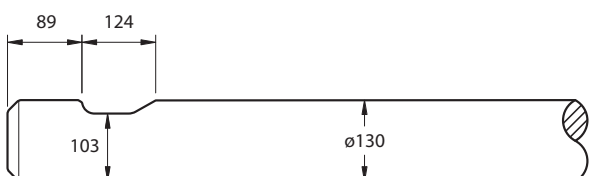

Point	1100	D080-1100P	102
Chisel	1100	D080-1100C	102
Blunt	1000	D080-1000B	93

Figure No.

TYPE      LENGTH MM      CATALOGUE NUMBER      WEIGHT KGS

198

**Rammer S82**

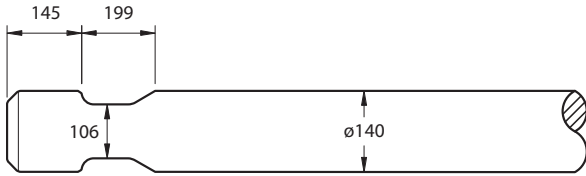

Point	1200	D081-1200P	137
Chisel	1200	D081-1200C	137
Blunt	1050	D081-1050B	122

199

**Rammer S83**

Caterpillar H140As

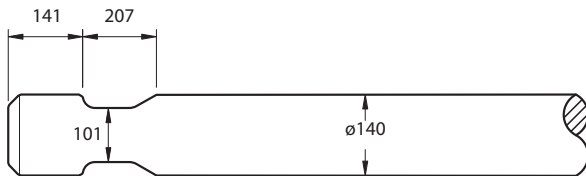

Point	1200	D082-1200P	137
Chisel	1200	D082-1200C	137
Blunt	1050	D082-1050B	122

200

**Rammer S84**

Caterpillar H160As

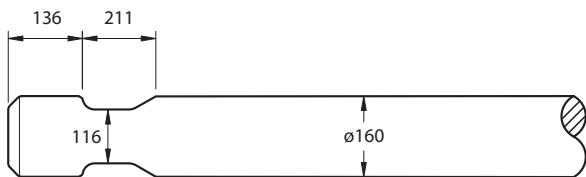

Point	1350	D084-1350P	195
Chisel	1350	D084-1350C	195
Blunt	1200	D084-1200B	173

201

**Rammer S86**

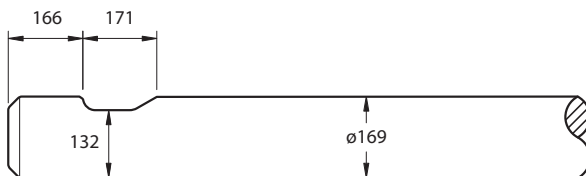

Point	1450	D085-1450P	240
Chisel	1450	D085-1450C	240
Blunt	1300	D085-1300B	215

202

**Rammer E63**

JCB HM1150, Volvo HB1100

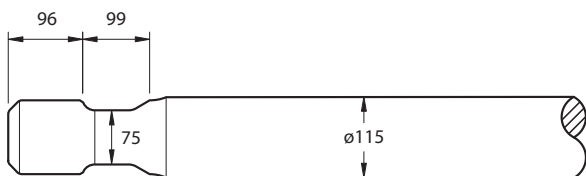

Point	1000	D099-1000P	68
Chisel	1000	D099-1000C	68

203

**Rammer E64**

Caterpillar H115s, Case CB1450, JCB HM1050, O&K H200

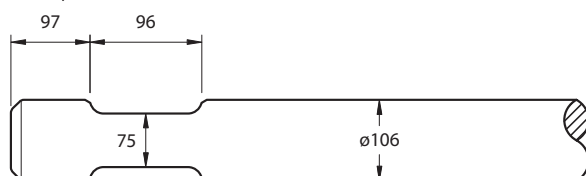

Point	1050	D088-1050P	64
Point	1150	D088-1150P	70
Chisel	1050	D088-1050C	64
Chisel	1150	D088-1150C	70

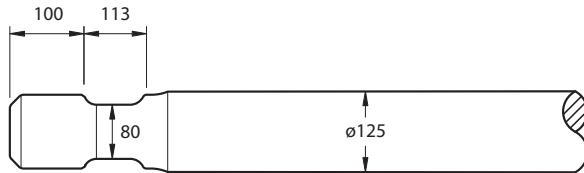

Figure No.

204

### Rammer E65

JCB HM1450, Volvo HB1400



TYPE	LENGTH MM	CATALOGUE NUMBER	WEIGHT KGS
------	-----------	------------------	------------

Point	1050	D095-1050P	80
Chisel	1050	D095-1050C	80
Blunt	850	D095-0850B	69

205

### Rammer E66/S55

Caterpillar H120s, Case CB2850, JCB HM1350, O&K H260

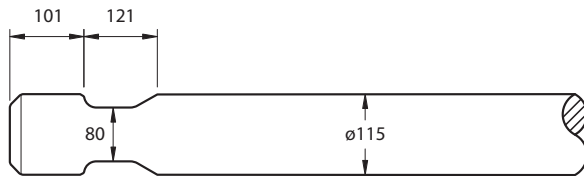

Point	1050	D079-1050P	80
Point	1150	D079-1150C	88
Chisel	1050	D079-1050C	80
Chisel	1150	D079-1150C	88
Blunt	950	D079-0950B	73

206

### Rammer E68

Caterpillar H130s, Case CB3750, JCB HM1750, O&K H310, Volvo HB1700

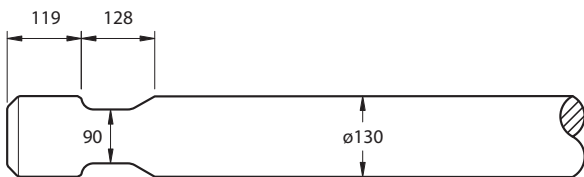

Point	1100	D086-1100P	102
Point	1200	D086-1200P	111
Chisel	1100	D086-1100C	102
Chisel	1200	D086-1200C	111
Blunt	900	D086-0900B	84

207

### Rammer G80

Caterpillar H140Cs/140Ds, Case CB4000, JCB HM2350, O&K H380, Volvo HB2400

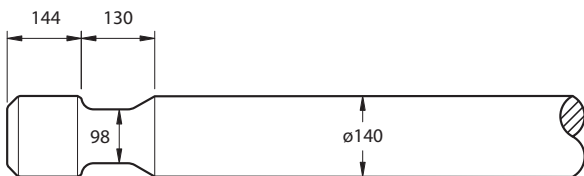

Point	1200	D092-1200P	137
Chisel	1200	D092-1200C	137
Blunt	1050	D092-1050B	122

208

### Rammer G90

Caterpillar H160Cs/160Ds, Case CB5200, JCB HM2950, O&K H530, Volvo HB3200

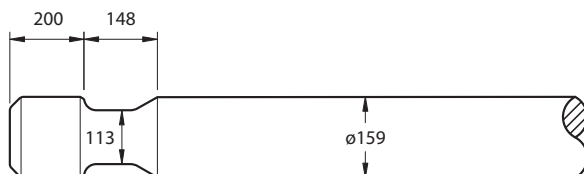

Point	1400	D094-1400P	206
Chisel	1400	D094-1400C	206
Blunt	1250	D094-1250B	184

209

### Rammer G100

Caterpillar H180s, JCB HM3850

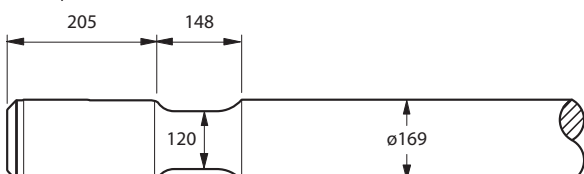

Point	1450	D089-1450P	240
Chisel	1450	D089-1450C	240
Blunt	1300	D089-1300B	215

Figure No.

210

### Rammer G110

Caterpillar H180Ds, JCB HM3950, O&K H700, Volvo HB3800

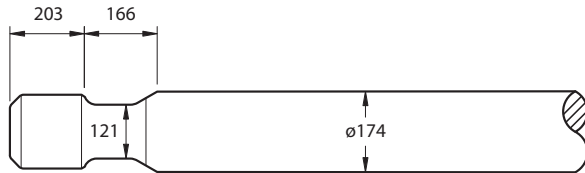

TYPE	LENGTH MM	CATALOGUE NUMBER	WEIGHT KGS
------	-----------	------------------	------------

Point	1450	D096-1450P	240
Chisel	1450	D096-1450C	240
Blunt	1300	D096-1300B	216

211

### Rammer G120

Caterpillar H195

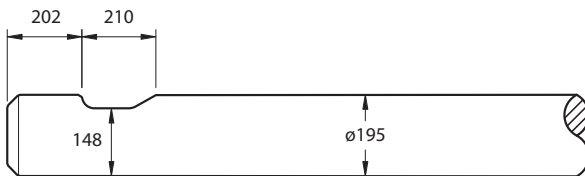

Point	1500	D093-1500P	326
Chisel	1500	D093-1500C	326
Blunt	1350	D093-1350B	294

212

### Rammer G130

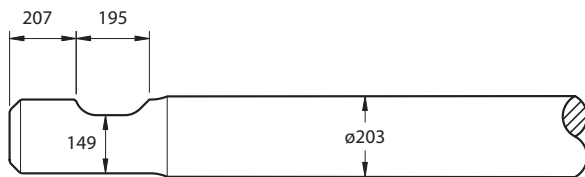

Point	1550	D097-1550P	340
Chisel	1550	D097-1550C	340
Blunt	1400	D097-1400B	308

213

### Rammer M14

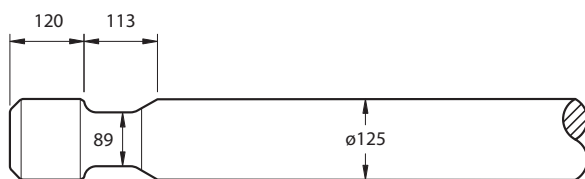

Point	1100	D800-1100P	92
Chisel	1100	D800-1100C	92

214

### Rammer M18

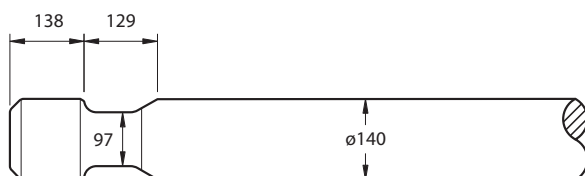

Point	1200	D801-1200P	137
Chisel	1200	D801-1200C	137
Blunt	1100	D801-1100B	126

Figure No.

215

**Rotair OL50**

Furukawa F1/HB1G, Gehl G50S

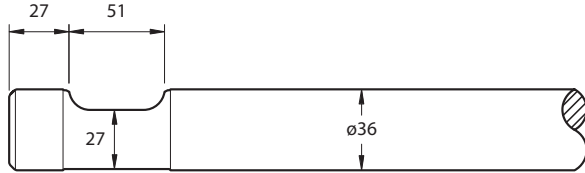

Point  
Chisel

400  
400

**D138-0400P**  
**D138-0400C**

2  
2

216

**Rotair OL90 (With Collar)**

Pel-Job MH90, Omal 80S

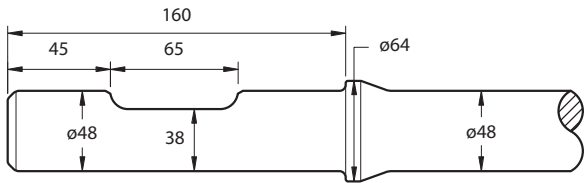

Point  
Chisel

480  
480

**D468-0480P**  
**D468-0480C**

5  
5

217

**Rotair OL90/95**

Pel-Job MH95, Gehl G95S

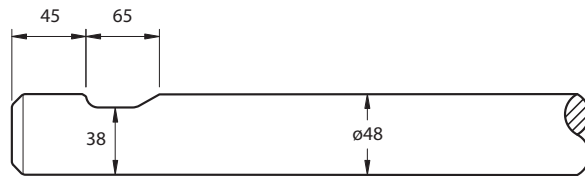

Point  
Chisel

480  
480

**D469-0480P**  
**D469-0480C**

5  
5

218

**Rotair OL130/160**

Pel-Job MH130/160, Gehl G160S

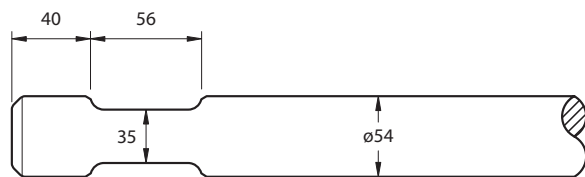

Point  
Chisel

500  
500

**D470-0500P**  
**D470-0500C**

7  
7

219

**Rotair OL180/260**

Pel-Job MH180/260, Gehl G260S

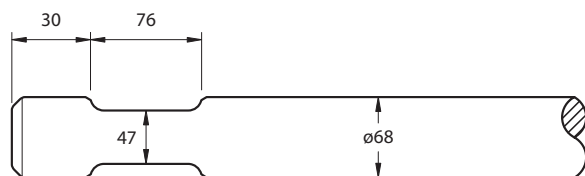

Point  
Chisel

550  
550

**D471-0550P**  
**D471-0550C**

14  
14

220

**Rotair OL250/330**

Gehl G330S

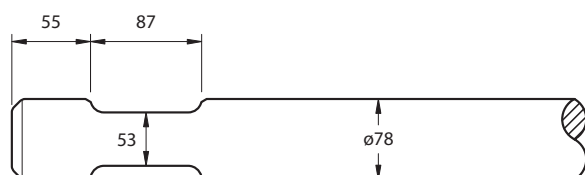

Point  
Chisel

600  
600

**D472-0600P**  
**D472-0600C**

19  
19

Figure  
No.

TYPE	LENGTH MM	CATALOGUE NUMBER	WEIGHT KGS
------	--------------	---------------------	---------------

221

**Socomec DMS 50**

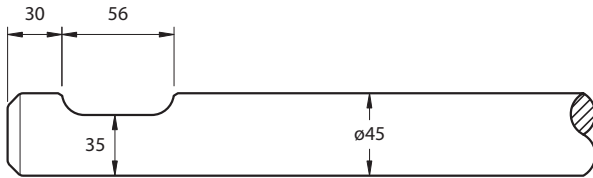

Point	350	D419-0350P	3
Chisel	350	D419-0350C	3

222

**Socomec DMS 95**

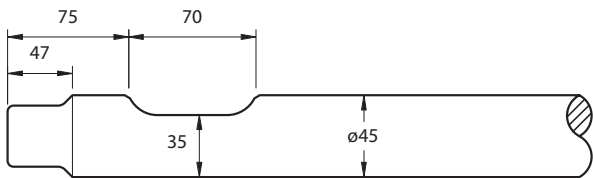

Point	480	D420-0480P	5
Chisel	480	D420-0480C	5

223

**Socomec DMS 160**

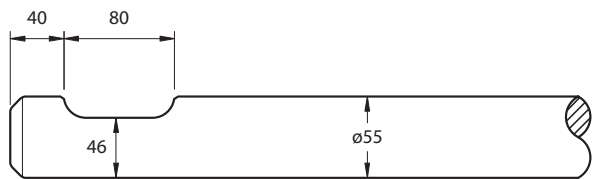

Point	570	D436-0570P	14
Chisel	570	D436-0570C	14

224

**Socomec DMS 220**

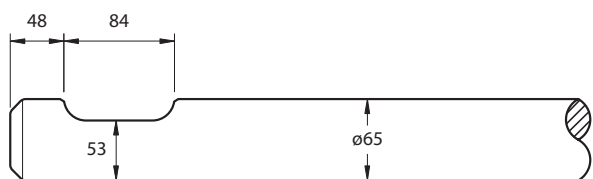

Point	600	D422-0600P	17
Chisel	600	D422-0600C	17

225

**Socomec DMS 330**

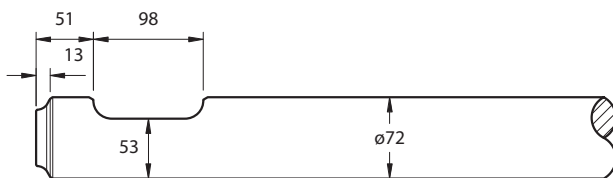

Point	700	D423-0700P	21
Chisel	700	D423-0700C	21

226

**Socomec DMS 430**

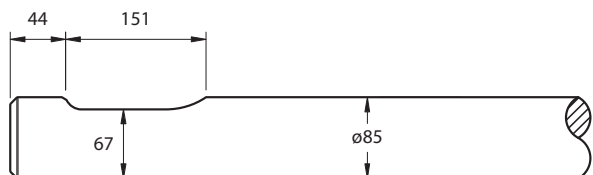

Point	780	D438-0780P	30
Chisel	780	D438-0780C	30

Figure No.

227

**Socomec DMS 740**

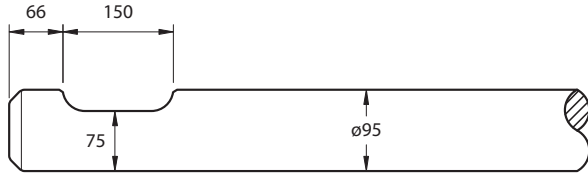

TYPE	LENGTH MM	CATALOGUE NUMBER	WEIGHT KGS
Point	900	D429-0900P	46
Chisel	900	D429-0900C	46

228

**Socomec MDO 550**

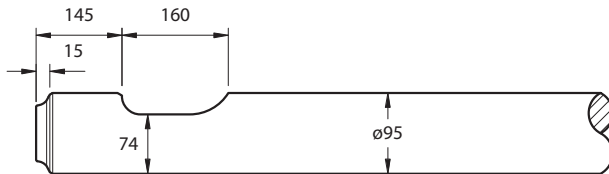

Point	970	D427-0970P	50
Chisel	970	D427-0970C	50

229

**Socomec MDO 750**

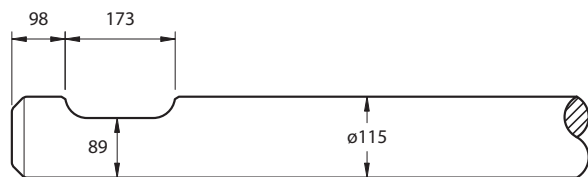

Point	1050	D428-1050P	80
Chisel	1050	D428-1050C	80

230

**Socomec MDO 1450**



Point	1150	D431-1150P	107
Chisel	1150	D431-1150C	107
Blunt	1050	D431-1050B	98

231

**Socomec MDO 1950**

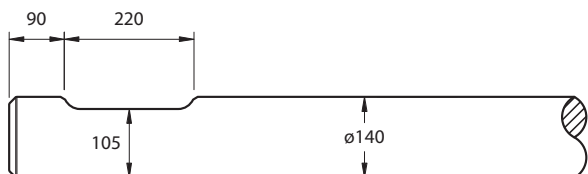

Point	1250	D432-1250P	142
Chisel	1250	D432-1250C	142
Blunt	1150	D432-1150B	131

Figure No.

TYPE	LENGTH MM	CATALOGUE NUMBER	WEIGHT KGS
------	-----------	------------------	------------

232

**Soosan SB10**

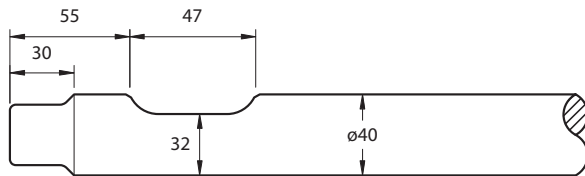

Point	450	D445-0450P	4
Chisel	450	D445-0450C	4

233

**Soosan SB20**

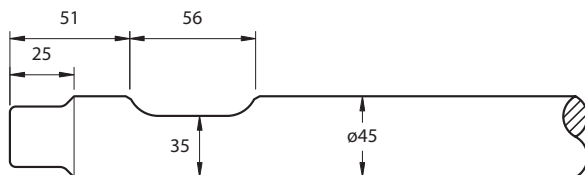

Point	500	D447-0500P	5
Chisel	500	D447-0500C	5

234

**Soosan SB30**

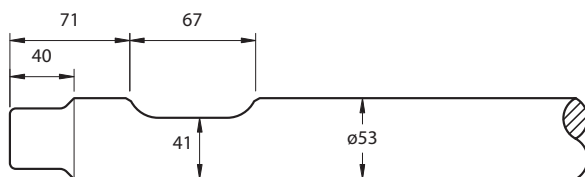

Point	570	D448-0570P	8
Chisel	570	D448-0570P	8

235

**Soosan SB40**

Stanley MB506

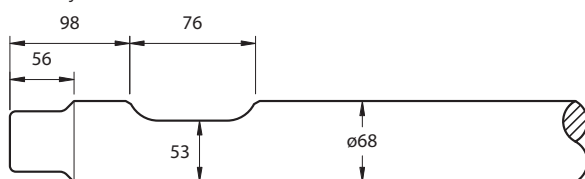

Point	710	D450-0710P	20
Chisel	710	D450-0710C	20

236

**Soosan SB43**

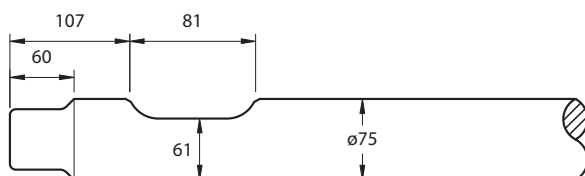

Point	800	D446-0800P	24
Chisel	800	D446-0800C	24

237

**Soosan SB45**

Stanley MB20EX

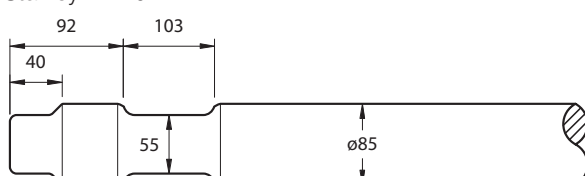

Point	850	D451-0850P	30
Chisel	850	D451-0850C	30

Figure No.

238

**Soosan SB50**  
Stanley MB30EX

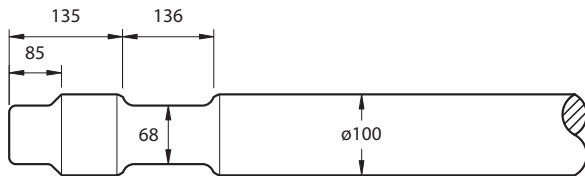

TYPE	LENGTH MM	CATALOGUE NUMBER	WEIGHT KGS
Point	1000	D452-1000P	55
Chisel	1000	D452-1000C	55

239

**Soosan SB60**  
Stanley MB40EX

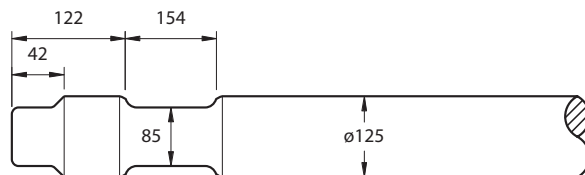

Point	1050	D453-1050P	98
Chisel	1050	D453-1050C	98

240

**Soosan SB81**  
Stanley MB50EX

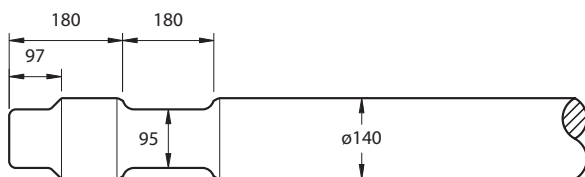

Point	1200	D457-1200P	125
Chisel	1200	D457-1200C	125
Blunt	1100	D457-1100B	115

241

**Soosan SB100**

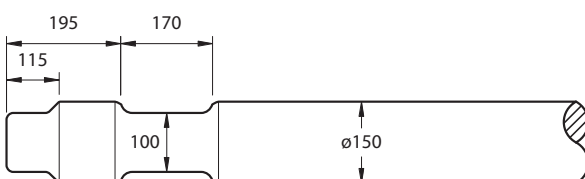

Point	1300	D460-1300P	178
Chisel	1300	D460-1300C	178
Blunt	1200	D460-1200B	165

242

**Soosan SB121**  
Stanley MB70EX

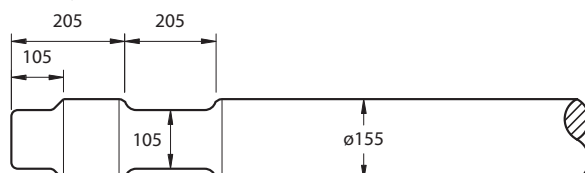

Point	1300	D458-1300P	190
Chisel	1300	D458-1300C	190
Blunt	1200	D458-1200B	176

Figure  
No.

TYPE	LENGTH MM	CATALOGUE NUMBER	WEIGHT KGS
------	--------------	---------------------	---------------

243

### Soosan SB130/140

Stanley MB80EX

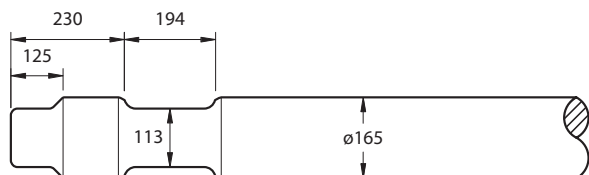

Point	1400	D449-1400P	208
Chisel	1400	D449-1400C	208
Blunt	1250	D449-1250B	186

244

### Soosan SB151

Stanley MB100EX

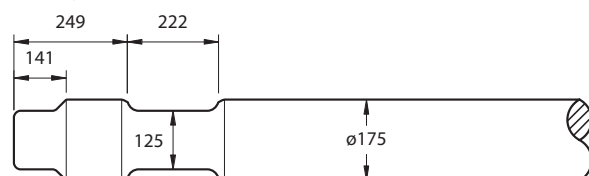

Point	1600	D459-1600P	300
Chisel	1600	D459-1600C	300
Blunt	1450	D459-1450B	272

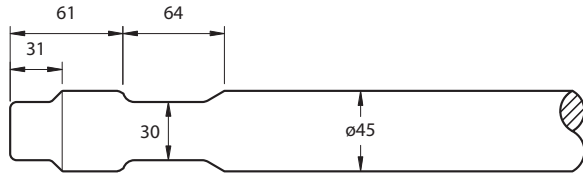

Figure No.

245

**Toku TNB-08E/1M**

Teledyne TB100



TYPE	LENGTH MM	CATALOGUE NUMBER	WEIGHT KGS
------	-----------	------------------	------------

Point	470	D851-0470P	5
Chisel	470	D851-0470C	5

246

**Toku TNB-1E/2M**

Drago DRH80, Teledyne TB120/125

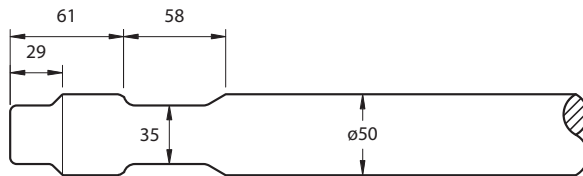

Point	500	D366-0500P	7
Point	600	D366-0600P	8
Chisel	500	D366-0500C	7
Chisel	600	D366-0600C	8

247

**Toku TNB-2E/3M**

Drago DRH120, Teledyne TB180/225

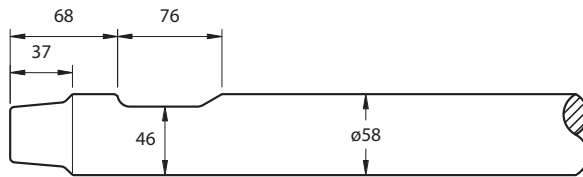

Point	650	D367-0650P	13
Point	700	D367-0700P	14
Chisel	650	D367-0650C	13
Chisel	700	D367-0700C	14

248

**Toku TNB-3E/4M**

Drago DRH150, Teledyne TB275

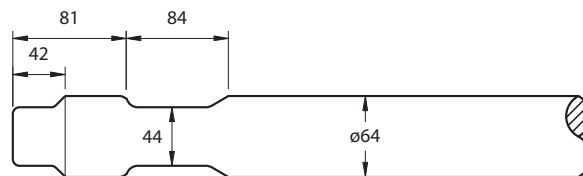

Point	650	D373-0650P	15
Point	700	D373-0700C	16
Chisel	650	D373-0650C	15
Chisel	700	D373-0700C	16

249

**Toku TNB-4E/5M**

Drago DRH180, Teledyne TB220/325

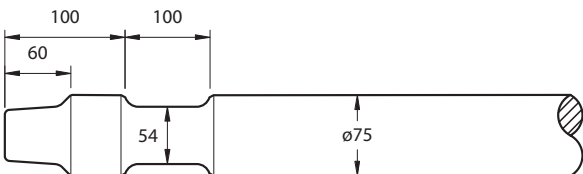

Point	650	D368-0650P	19
Point	720	D368-0720C	21
Chisel	650	D368-0650C	19
Chisel	720	D368-0720C	21

250

**Toku TNB-6E/7M**

Drago DRH 280, Teledyne TB400/425/625

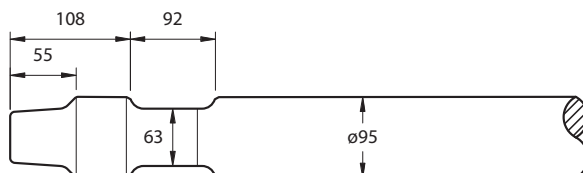

Point	760	D369-0760P	39
Point	850	D369-0850P	44
Chisel	760	D369-0760C	39
Chisel	850	D369-0850C	44

Figure No.

251

### Toku TNB-7E/10E

Drago DRH650S/900, Teledyne TB700/725/750/825

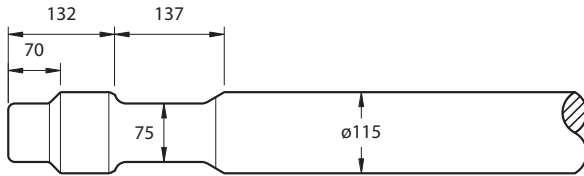

TYPE	LENGTH MM	CATALOGUE NUMBER	WEIGHT KGS
Point	950	D370-0950P	72
Point	1000	D370-1000P	76
Chisel	950	D370-0950C	72
Chisel	1000	D370-1000C	76

252

### Toku TNB-14E/16E

Drago DRH1150S/1600S, Teledyne TB900/925/975/1000/1025

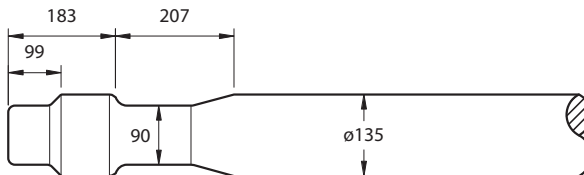

Point	1150	D371-1150P	115
Chisel	1150	D371-1150C	115
Blunt	1050	D371-1050B	105

253

### Toku TNB-22E/23E

Drago DRH1900, Teledyne TB1300/1425

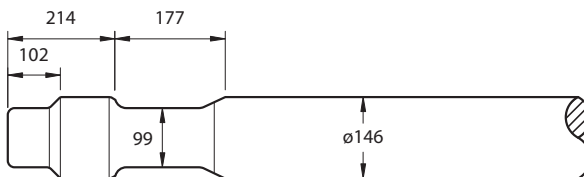

Point	1300	D371-1300P	145
Chisel	1300	D371-1300C	145
Blunt	1150	D371-1150B	129

254

### Toku TNB-30E/31E

Teledyne TB1825/2075

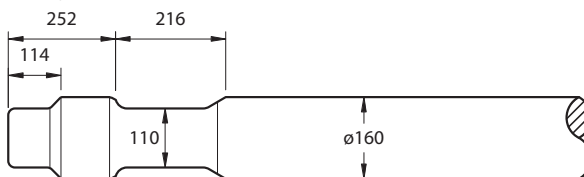

Point	1500	D374-1500P	217
Chisel	1500	D374-1500C	217
Blunt	1350	D374-1350B	196

255

### Toku TNB-100

Teledyne TB830

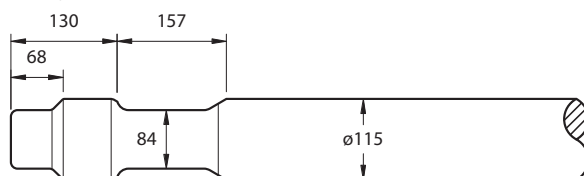

Point	1050	D852-1050P	80
Chisel	1050	D852-1050C	80

Figure No.

256

**Toku TNB-150**

Teledyne TB 980

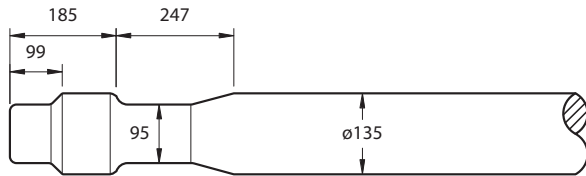

TYPE	LENGTH MM	CATALOGUE NUMBER	WEIGHT KGS
Point	1180	D853-1180P	118
Point	1270	D853-1270P	118
Chisel	1180	D853-1180C	127
Chisel	1270	D853-1270C	127
Blunt	1100	D853-1100B	110

257

**Toku TNB-190**

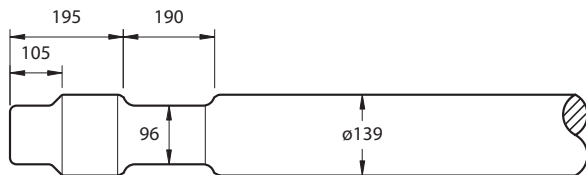

Point	1200	D854-1200P	137
Chisel	1200	D854-1200C	137
Blunt	1100	D854-1100B	126

258

**Toku TNB-230**

Teledyne TB1680

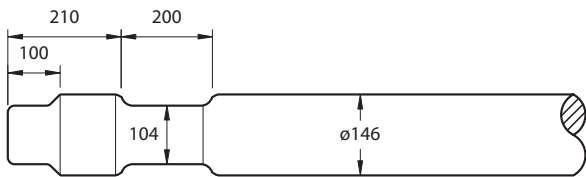

Point	1220	D855-1220P	151
Chisel	1220	D855-1220C	151
Blunt	1100	D855-1100B	136

259

**Toku TNB-310**

Teledyne TB 2080

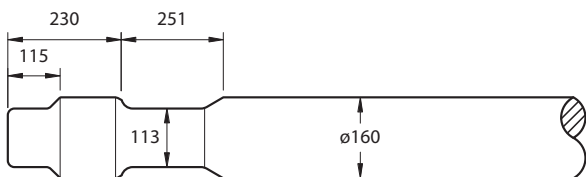

Point	1350	D856-1350P	212
Chisel	1350	D856-1350C	212
Blunt	1200	D856-1200B	189

260

**Toku TNB-400**

Teledyne TB 2580

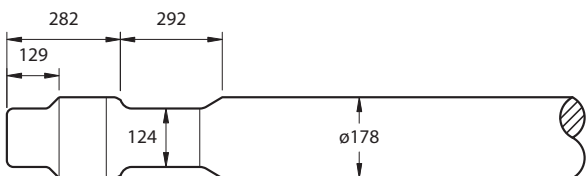

Point	1550	D858-1550P	310
Chisel	1550	D858-1550C	310
Blunt	1400	D858-1400B	378

Figure No.

TYPE	LENGTH MM	CATALOGUE NUMBER	WEIGHT KGS
------	-----------	------------------	------------

261

**Toyo THBB31**

Dehaco DHB35, JKHB31, Takeuchi TKB31

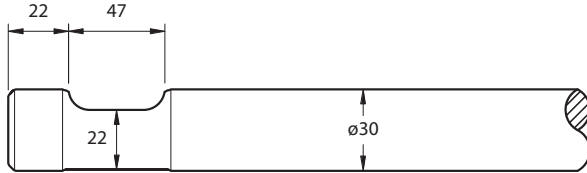

Point	350	D480-0350P	2
Chisel	350	D480-0350C	2

262

**Toyo THBB51**

Dehaco DHB55, JKHB51, Takeuchi TKB51



Point	400	D481-0400P	4
Chisel	400	D481-0400C	4

263

**Toyo THBB71**

Dehaco DHB75, JKHB71, Takeuchi TKB71

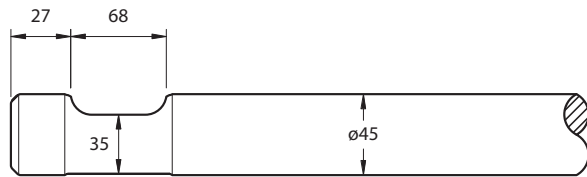

Point	450	D482-0450P	5
Chisel	450	D482-0450C	5

264

**Toyo THBB101**

Dehaco DHB165, JKHB101, Takeuchi TKB101

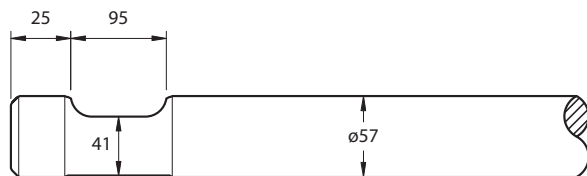

Point	550	D483-0550P	10
Chisel	550	D483-0550C	10

265

**Toyo THBB201**

Takeuchi TKB201

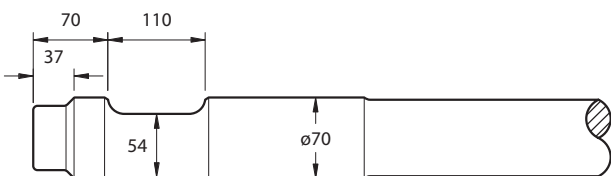

Point	700	D492-0700P	19
Chisel	700	D492-0700C	19

Figure No.

266

**Toyo THBB301**

Dehaco DHB305, JKHB301, Takeuchi TKB301



TYPE	LENGTH MM	CATALOGUE NUMBER	WEIGHT KGS
Point	750	D484-0750P	21
Chisel	750	D484-0750C	21

267

**Toyo THBB401**

Dehaco DHB405, JKHB401, Takeuchi TKB 401

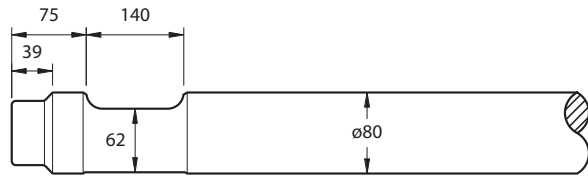

Point	900	D485-0900P	30
Chisel	900	D485-0900C	30

268

**Toyo THBB801**

Dehaco DHB805, JKHB801, Takeuchi TKB801

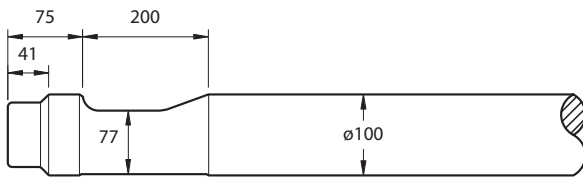

Point	960	D486-0960P	53
Chisel	960	D486-0960C	53

269

**Toyo THBB1101**

Dehaco DHB1250, JKHB1101, Takeuchi TKB1101

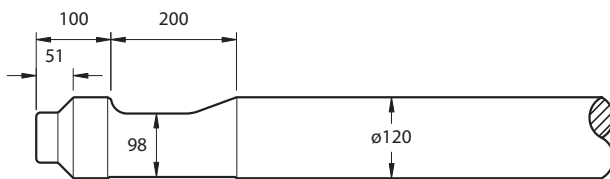

Point	1050	D487-1050P	91
Chisel	1050	D487-1050C	91

270

**Toyo THBB1401**

Dehaco DHB1305, JKHB 1401, Takeuchi TKB1401

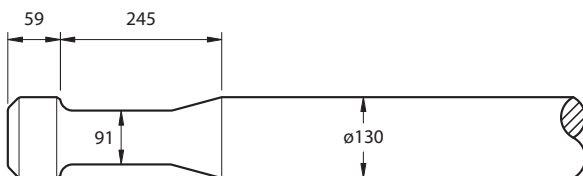

Point	1050	D488-1050P	101
Chisel	1050	D488-1050C	101

Figure No.

TYPE	LENGTH MM	CATALOGUE NUMBER	WEIGHT KGS
------	-----------	------------------	------------

271

### Toyo THBB1600

Dehaco DHB1605 (1405), JKHB1600, Takeuchi TKB1600

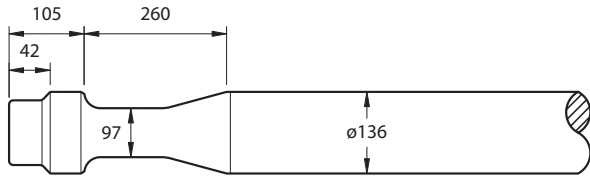

Point	1120	D489-1120P	115
Chisel	1120	D489-1120C	115
Blunt	1020	D489-1020B	105

272

### Toyo THBB2000

Dehaco DHB2305, JKHB2000, Takeuchi TKB2000

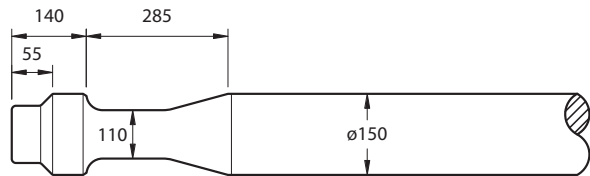

Point	1250	D490-1250P	173
Chisel	1250	D490-1250C	173
Blunt	1150	D490-1150B	160

273

### Toyo THBB3000

Dehaco DHB3205 (4105), JKHB3000, Takeuchi TKB3000

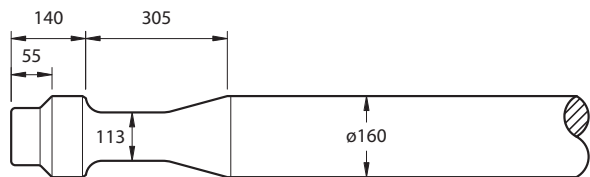

Point	1400	D491-1400P	220
Chisel	1400	D491-1400C	220
Blunt	1250	D491-1250B	197

# Other Manufacturers Reference Index

Fig No.	Hammer Type	Diameter mm	Length mm	Cat. No.	Weight kgs
<b>ARDEN</b>					
275	AB 100	45	500	D790-0500P/C	5
276	AB 150/210	57	600	D793-0600P/C	11
277	AB 280/350	70	680	D794-0680P/C	20
279	AB 450	80	840	D795-0840P/C	27
280	AB 1050	105	1050	D791-1050P/C	68
<b>ARROWHEAD</b>					
281	S20	45	480	D620-0480P/C	5
282	S30	53	500	D621-0500P/C	7
283	S40	65	620	D622-0620P/C	14
284	S60	75	710	D624-0710P/C	24
285	10T	105	950	D618-0950P/C	62
286	22T	126	1100	D619-1100P/C	93
<b>BOBCAT</b>					
329	1250	45	430	D317-0430P/C	4
330	1560	45	450	D330-0430P/C	5
331	2500/2570/3560	64	560	D318-0560P/C	12
332	5500	70	710	D320-0710P/C	20
333	6560	77	700	D321-0700P/C	22
<b>DAEMO</b>					
287	DMB S500	70	680	D343-0680P/C	20
288	DMB S1300	105	930	D344-0930P/C	60
289	DMB S1800	120	1000	D345-1000P/C	84
290	DMB S2200	135	1200	D346-1200P/C	120
291	DMB S3000	140	1250	D347-1250P/C	143
292	DMB S3600	150	1350	D348-1350P/C	185
<b>D&amp;A</b>					
275	8V	45	500	D790-0500P/C	5
276	15V/20V	57	600	D793-0600P/C	11
277	30V/50V	70	680	D794-0680P/C	20
278	70V	80	840	D795-0840P/C	27
280	130V	105	1050	D791-1050P/C	68
293	180V	125	1150	D792-1150P/C	97
<b>HUSKIE/IZUMI</b>					
294	HH100	40	400	D579-0400P/C	3
295	HH150	50	500	D580-0500P/C	6
296	HH300	60	600	D581-0600P/C	11
297	HH500	65	600	D582-0600P/C	13
298	HH750	75	750	D583-0750P/C	25
299	HH1000	90	850	D584-0850P/C	34
300	HH2000	115	1000	D586-1000P/C	76
301	HH3600	135	1150	D587-1150P/C	115
302	HH4500	145	1250	D588-1250P/C	153
<b>LIFTON</b>					
303	LH70/80	46	420	D390-0420P/C	4
304	LH110	55	460	D391-0460P/C	7
305	LH170	70	550	D392-0550P/C	16
306	LH360	82	700	D393-0700P/C	24
307	LH500	100	780	D394-0780P/C	43
308	LH1000	130	940	D395-0940P/C	91

# Other Manufacturers Reference Index

Fig No.	Hammer Type	Diameter mm	Length mm	Cat. No.	Weight kgs
<b>OKADA</b>					
309	OKB/UB 301	50	500	D280-0500P/C	6
310	OKB/UB 301SL	54	550	D281-0550P/C	8
311	OKB/UB 302	61	550	D297-0550P/C	11
312	OKB/UB 302A	61	600	D282-0600P/C	12
313	OKB/UB 303A	66	700	D283-0700P/C	16
314	OKB/UB 304	74	850	D284-0850P/C	25
315	OKB/UB 304B	74	750	D298-0750P/C	25
316	OKB/UB 305	85	900	D285-0900P/C	32
317	OKB/UB 308	110	1000	D287-1000P/C	61
318	OKB/UB 310	122	1100	D288-1100P/C	100
319	OKB/UB 312B	130	1150	D289-1150P/C	108
320	OKB/UB 316	140	1300	D290-1300P/C	130
321	OKB/UB 318	150	1400	D291-1400P/C	193
322	UB 2	60	550	D277-0550P/C	10
323	UB 4	68	700	D278-0700P/C	18
324	UB 5	80	800	D279-0800P/C	25
325	UB 8	98	1000	D293-1000P/C	54
326	UB11	122	1100	D294-1100P/C	100
327	UB14	135	1200	D295-1200P/C	115
328	UB17/OKB17A2	137	1300	D296-1300P/C	127
<b>STANLEY</b>					
329	MB 125	45	430	D317-0430P/C	4
330	MB156	45	450	D330-0450P/C	5
331	MB 250/256/350/356	64	560	D318-0560P/C	12
332	MB 550	70	710	D320-0710P/C	20
333	MB 656/675/695	77	700	D321-0700P/C	22
334	MB 800/856	80	770	D322-0770P/C	26
335	MB 1550	102	915	D323-0915P/C	52
336	MB 1950/1975	114	1050	D324-1050P/C	80
337	MB 2950/2975	130	1000	D326-1000P/C	92
338	MB 3950	140	1250	D328-1250P/C	142
<b>TABE</b>					
341	AGB 100/175/200	50	450	D300-0450P/C	6
342	AGB 270/275/350/375	65	620	D302-0620P/C	15
343	AGB 400/475	85	700	D303-0700P/C	28
344	AGB 700/701/750	105	850	D304-0850P/C	57
345	AGB 1000/1300/1301	114	1000	D305-1000P/C	76
346	AGB 1600/1620	130	1150	D306-1150P/C	107
347	AGB 1800	135	1100	D307-1100P/C	119
<b>TOPA</b>					
348	TOPA 70	45	500	D570-0500P/C	5
349	TOPA 100	56	630	D571-0630P/C	12
350	TOPA 200	65	740	D572-0740P/C	17
351	TOPA 300	70	810	D573-0810P/C	23
352	TOPA 500	85	980	D574-0980P/C	39
353	TOPA 1000	99	1100	D575-1100P/C	61
354	TOPA 1400	132	1350	D577-1350P/C	110
355	TOPA 1500	134	1350	D576-1350P/C	115
<b>VIBRARAM</b>					
295	VRH-50	50	500	D580-0500P/C	6
296	VRH-60	60	600	D581-0600P/C	11
298	VRH-75	75	750	D583-0750P/C	25
299	VRH-90	90	850	D584-0850P/C	34
300	VRH-115	115	1000	D586-1000P/C	76
301	VRH-135	135	1150	D587-1150P/C	115
302	VRH-145	145	1250	D588-1250P/C	153



# Warranty Guide

The purpose of this guide is to provide advice on the correct application of P&V Demolition Tools and assist in analysing and resolving any complaints immediately they occur.

## Cause and Effect of Fatigue Failures

The continuous cycle of compressive and tensile stresses in a Demolition Tool, even under correct operating conditions, creates fatigue stress in the tool which can lead to fatigue failure of the tool before it is worn out. Anything which interferes with the normal operational cycle of compressive and tensile stresses will increase the level of fatigue stress being applied to the tool, increasing the risk of early fatigue failure.

### 1) Leverage/Bending

The main cause of increased fatigue stress in a demolition tool is any form of side pressure during service which creates bending. Utilising the tool as a lever, using the incorrect driving angle or attempting to break ground using the “pull” of the machine are all detrimental to the life of a demolition tool and should be avoided (see Figure 1).

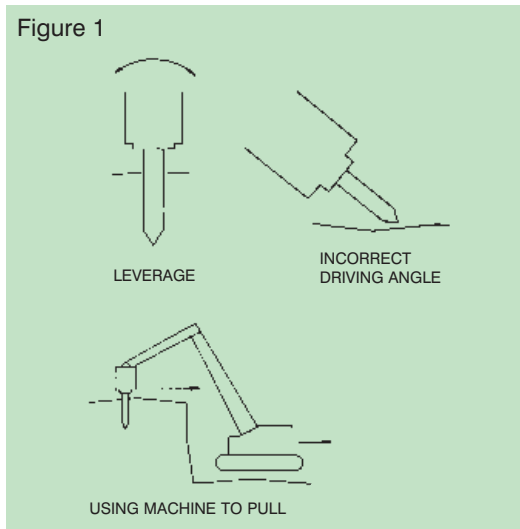

### 2) “Free Running”/“Blank Firing”

This can arise in any situation where the working end is not in proper contact with the material to be broken. This includes jobs where the tool slides off the work and also when break-through of thin concrete slabs or boulders occurs. It is essential that the tool is applied at a right-angle to the working surface at all times.

### 3) Lubrication

Regular lubrication is essential. Any form of damage to the surface of a demolition tool renders it more liable to suffer fatigue failure. Care must be taken to prevent accidental gouging or contact welding (“galling” or “pick-up”) due to contact between the tool and chuck bushings either through lack of lubrication or excessive leverage (see Figure 2).

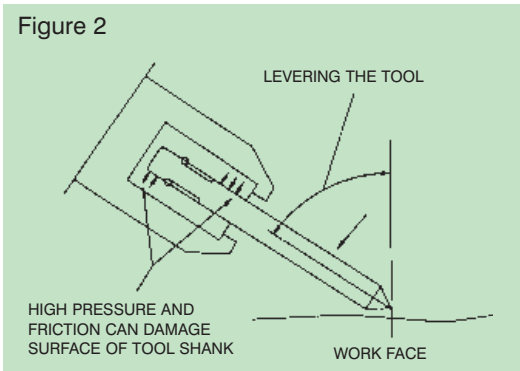

### 4) Cold/Corrosion

Low temperature causes a Demolition Tool to be more susceptible to fatigue failure. Tools should be kept sheltered from the weather when not in use. A rusty Demolition Tool is more likely to suffer fatigue failure, so tools should be kept well greased.

### 5) Worn Internal Hammer Parts

Worn hammer parts can cause the tool to be held too “loosely”. This can create surface damage on the tool, which can lead to fatigue failure of the tool. Worn parts can also cause uneven striking on the tool, which may lead to fatigue failure of the tool and damage to the piston.

*continued on next page*

## 6) Typical Failures (Guide to Warranty Claims)

P&V Demolition Tools are manufactured from first class materials and then heat-treated to produce tools with optimum fatigue and wear resistance. When a tool has apparently failed to give satisfactory service life, a brief visual inspection can often give a quick indication of the cause.

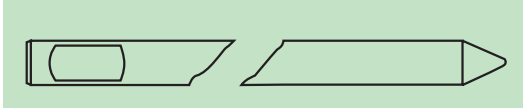
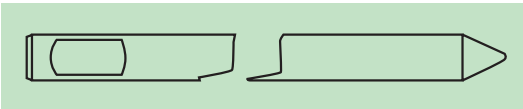
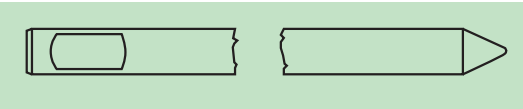

a) Typical fractures caused by excessive bending/leverage of the demolition tool. Warranty claims rejected.

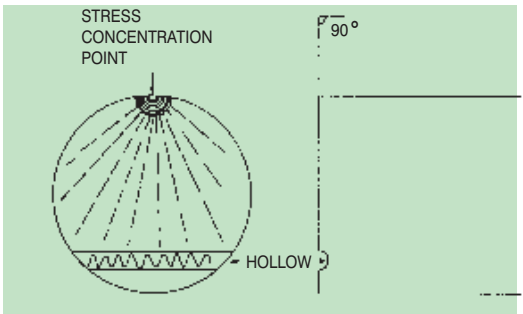

b) Typical of high stress fracture, usually caused by using the tool as an anchor to "pull" the machine. Warranty claims rejected

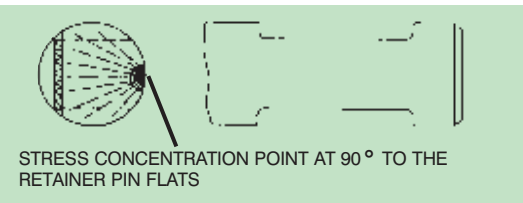

c) Typical fracture caused by levering tool whilst buried in the burden. Warranty claims rejected.

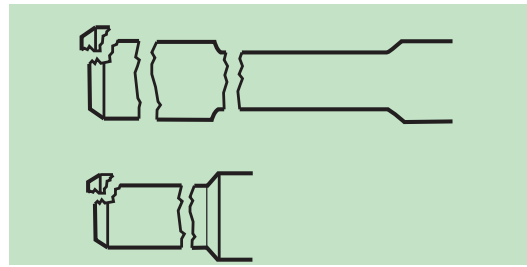

d) Typical fractures caused by blank firing and/or excessive chuck bush wear/damage. Warranty claims rejected.

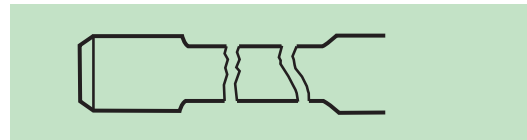

e) Typical fractures caused by blank firing and/or twisting of the tool due to worn/damaged retainer pin. Warranty claims rejected.

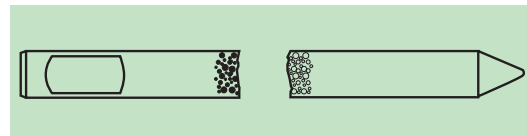

f) Typical fracture caused by lack of lubrication and/or chuck bush wear/damage. Warranty claims rejected.

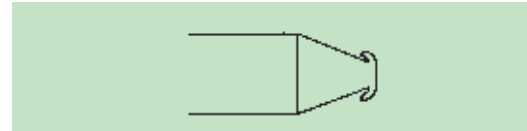

g) Mushrooming: this is caused by driving the chisel or point into hard dense material for too long a period of time without penetration. This generates intense heat, softening the point and causing it to "mushroom". This is not a manufacturing fault. Warranty claims rejected.



h) Note fatigue lines originate from the internal point, not outer diameter. Very rare failure type due to steel defect. 100% warranty accepted.